

Features

- Q TO-220 housing
- Q Low inductance
- Q Resistor electrically isolated from the backplate
- Q High power rating
- Q AEC-Q200 qualified
- Q RoHS compliant*

Applications

- Q Power supplies
- Q Motor drives
- Q Test and measurement
- Q Rectifiers

PWR220T-35 Series Power Resistor

General Information

Bourns® 3576 HV L D 7 2 3 5 W O H S R Z H V L W R O D D F M G X D K S P R O R Q D F D P E H K B O R Y W L X H G B O P H D V M P H V O V B O H H G H D Q G L K D H B V

Electrical & Thermal Characteristics

Parameter	Value(s)
Resistance	0.02 1 to 130 K1
Power Rating	35 W
Tolerance	"
Temperature Coefficient	±330%
Inductance	≤ 10 nH
Operating Voltage	335 V
Dielectric Strength	10 kV
Insulation Resistance	10 G1

Reliability Characteristics

Parameter	Value(s)
Resistance to Soldering Heat (10 seconds at 260°C)	6R ±0.25 %
Resistance to Soldering Heat (10 seconds at 350°C)	6R ±1.0 %
Resistance to Soldering Heat (10 seconds at 400°C)	6R ±0.5 %
Resistance to Soldering Heat (10 seconds at 450°C)	6R ±0.5 %
Resistance to Soldering Heat (10 seconds at 500°C)	6R ±0.2 %
Resistance to Soldering Heat (10 seconds at 550°C)	6R ±0.5 %
Resistance to Soldering Heat (10 seconds at 600°C)	6R ±0.5 %
Resistance to Soldering Heat (10 seconds at 650°C)	6R ±0.5 %

Material Characteristics

Resistor 7K1P
 Housing SR1
 Pins 7G&SSH60
 8R&BVWR0

Packaging

..... SFW0

Typical Part Marking

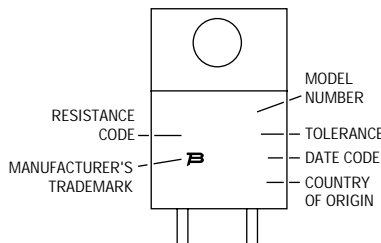

Popular Resistance Values

Code	Resistance Value	Code	Resistance Value
R020	W	1000	W
R025	W	1200	W
R030	W	1500	W
R033	W	2000	W
5 W		2500	W
R050	W	3000	W
R075	W	3300	W
R100	W	W	
R150	W	W	
R200	W	5000	W
R250	W	5600	W
R300	W	7500	W
R330	W	1001	.W
5 W		1501	.W
R500	W	2001	.W
R750	W	2501	.W
1R00	W	3001	.W
1R50	W	3301	.W
2R00	W	.W	
2R50	W	5001	.W
3R00	W	7501	.W
3R30	W	1002	.W
5 W		1502	.W
5R00	W	2002	.W
7R50	W	2502	.W
5 W		3002	.W
10R0	W	3302	.W
12R0	W	.W	
15R0	W	.W	
20R0	W	5002	.W
25R0	W	5602	.W
27R0	W	.W	
30R0	W	7502	.W
33R0	W	.W	
5 W		1003	.W
5 W		1153	.W
50R0	W	1203	.W
56R0	W	1253	.W
75R0	W	1303	.W

*** 5 % Tolerance

*RoHS Directive 2002/95/EC Jan. 27, 2003 including annex and RoHS Recast 2011/65/EU June 8, 2011. Specifications are subject to change without notice.

The device characteristics and parameters in this data sheet can and do vary in different applications and actual device performance may vary over time. Users should verify actual device performance in their specific applications.

Product Dimensions

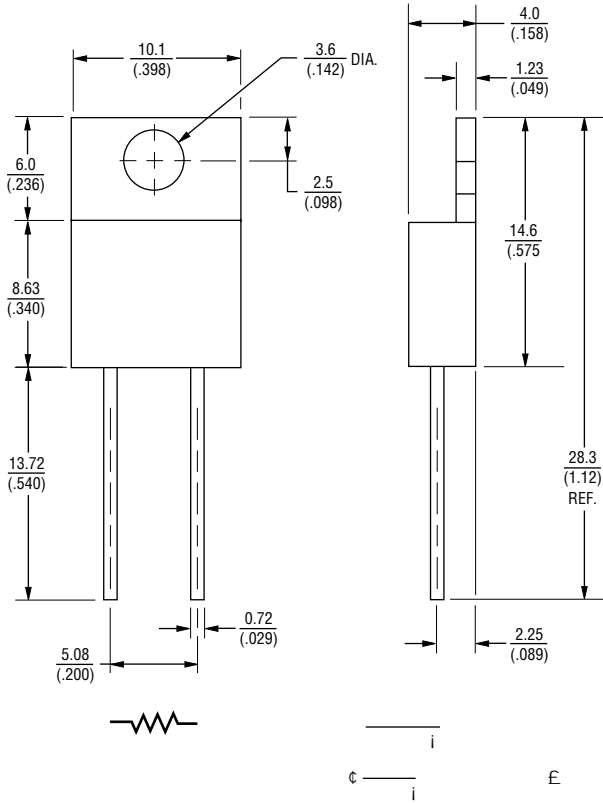

Pulse Power Rating

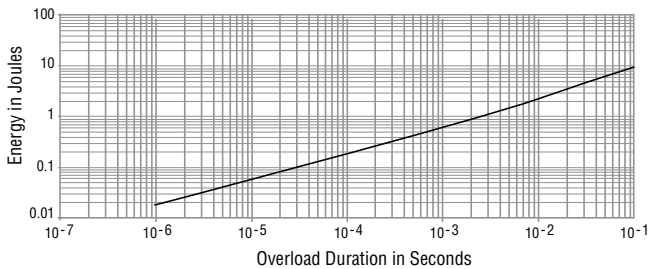

7JDEES-ODE
D00DE0SOJSDSSOD
OJSO

7J00JDS
70D0DJOD
SDJODJ

How to Order

PWR 220 T - 35 - 10R0 F

Model _____
PWR = Power Resistor

Package _____
220 = TO-220 Style

Pin Style _____
T = Through-hole

Power _____
35 = 35 W

Resistance Value _____
RKPV ... 5HSHVHV VGHFEDOSRW
HDPSOHV5 1; R500 = 0.5 1

*RKPV ... 1VWVKHGV VDEHVADWIRWKGWBSHVHV
REHBIHVWRIROORZ
HDPSOHV RKPV .RKPV

EVROWH7ROHDSH
-
F = 1 %

Derating Curve

