

SUMMARY

Wires

| | |
|---------|----|
| Low | 20 |
| High | 0 |
| Coax | 0 |
| Triax | 0 |
| Quad | 0 |
| Fiber | 0 |
| Fluidic | 0 |



Image is for illustrative purpose only

Download

[Request a quote](#)

[Catalog](#)

| | |
|------------------|----------------|
| Series | 4B |
| Termination type | Female crimp |
| IP rating | 50 |
| Cable Ø | 7.80 - 9.20 mm |
| Matching parts | |
| Status | active |
| Alternative part | |

TECHNICAL DETAILS

Mechanics

| | |
|-------------------|---|
| Shell Style/Model | PF*: Fixed receptacle, with two nuts, cable collet (back panel mounting) |
| Keying | 1 key (alpha=0, plug: male contacts, receptacle: female contacts) |
| Housing Material | Brass (chrome plated) shell and collet nut, nickel plated brass latch sleeve and mid pieces |
| Cable Fixing | ∅ 7.8 - 9.2 mm |
| Variant | Z : Nut for fitting a bend relief |
| Weight | 167.20 g |

Performance

| | |
|---------------|----------------------------|
| Configuration | 4B.320 : 20 Low Voltage |
| Insulator | Y: PEEK for crimp contacts |
| Rated Current | 8 Amps |

Specifications

Contact Type: Crimp
Max. Matings: 5000

LEMO products and services are provided "as is". LEMO makes no warranties or representations with regard to LEMO product & services or use of them, express, implied or statutory, including for accuracy, completeness, or security. The user is fully responsible for his products and applications using LEMO components.

Contact Retention: 30 N
 Contact Dia.: 0.9 mm (0.035in)
 Bucket Dia.: 1.1 mm (0.043in)
 Min. Conductor: 0.25 mm² (AWG 24)
 Max. Conductor: 0.5 mm² (AWG 20)
 R (max): 4.8 mOhm
 Vtest (contact-shell): 950 V (AC), 1340 V (DC)
 Vtest (contact-contact): 1050 V (AC), 1490 V (DC)

Others

Temp (min / max): -55° C / +250° C
 Humidity (max): <=95% [at 60 deg C / 140 F]
 Vibration: 15 g [10 Hz - 2000 Hz]
 Shock Resistance: 100 g [6 ms]
 Salt Spray Corrosion: >1000 hr
 Climatical Category: 50/175/21
 Shielding (min): 75 dB (10 MHz)
 Shielding (min): 40 dB (1 GHz)
 IP Rating: 50

DRAWINGS

Draws

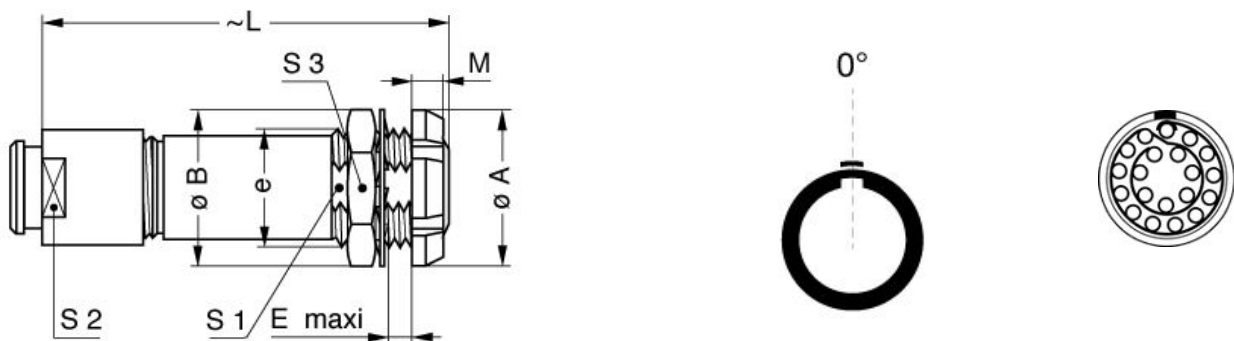

Dimensions

| | A | B | E | L | M | S1 | S2 | S3 | e |
|-----|------|------|------|------|------|------|------|------|---------|
| mm. | 30 | 32 | 11 | 69 | 4.5 | 23.5 | 20 | 30 | M25x1.0 |
| in. | 1,18 | 1,26 | 0,43 | 2,72 | 0,18 | 0,93 | 0,79 | 1,18 | |

LEMO products and services are provided "as is". LEMO makes no warranties or representations with regard to LEMO product & services or use of them, express, implied or statutory, including for accuracy, completeness, or security. The user is fully responsible for his products and applications using LEMO components.

RECOMMENDED BY LEMO

Tools

Crimp Tool: DPC.91.701.V

Crimp settings: AWG/Selector = 20-22-24/6-5-5

Positionner: DCE.91.094.BVM

Extractor: DCF.91.093.5LT

Replacement contact: EGG.4B.660.ZZM

Cables

| | | | |
|--------------------|-----|-------|---|
| CMN.20.T22.084PGCE | PVC | GREY |  |
| CMN.20.T22.084PGZE | | Grey |  |
| CMN.20.T22.084PNCE | PVC | Black |  |
| CMN.20.T22.084PNZE | | |  |
| 420 250 | PVC | Grey |  |

LEMO products and services are provided "as is". LEMO makes no warranties or representations with regard to LEMO product & services or use of them, express, implied or statutory, including for accuracy, completeness, or security. The user is fully responsible for his products and applications using LEMO components.