

SUMMARY

Wires

| | |
|---------|----|
| Low | 18 |
| High | 0 |
| Coax | 0 |
| Triax | 0 |
| Quad | 0 |
| Fiber | 0 |
| Fluidic | 0 |



Image is for illustrative purpose only

Download

[Request a quote](#)

[Catalog](#)

Series

| | |
|------------------|-------------------|
| Termination type | Female crimp |
| IP rating | 50 |
| Cable Ø | 8.30 - 9.20 mm |
| Matching parts | FGG.2B.318.CYCD92 |
| Status | active |
| Alternative part | |

TECHNICAL DETAILS

Mechanics

| | |
|-------------------|---|
| Shell Style/Model | PF*: Fixed receptacle, with two nuts, cable collet (back panel mounting) |
| Keying | 1 key (alpha=0, plug: male contacts, receptacle: female contacts) |
| Housing Material | Brass (chrome plated) shell and collet nut, nickel plated brass latch sleeve and mid pieces |
| Cable Fixing | ∅ 8.3 - 9.2 mm |
| Variant | |

Performance

| | |
|---------------|----------------------------|
| Configuration | 2B.318 : 18 Low Voltage |
| Insulator | Y: PEEK for crimp contacts |
| Rated Current | 5.5 Amps |

Specifications

| |
|-------------------------|
| Contact Type: Crimp |
| Max. Matings: 5000 |
| Contact Retention: 22 N |

LEMO products and services are provided "as is". LEMO makes no warranties or representations with regard to LEMO product & services or use of them, express, implied or statutory, including for accuracy, completeness, or security. The user is fully responsible for his products and applications using LEMO components.

Contact Dia.: 0.7 mm (0.028in)
 Bucket Dia.: 0.8 mm (0.031in)
 Min. Conductor: 0.14 mm² (AWG 26)
 Max. Conductor: 0.34 mm² (AWG 22)
 R (max): 6.1 mOhm
 Vtest (contact-shell): 2100 V (AC), 2970 V (DC)
 Vtest (contact-contact): 1450 V (AC), 2050 V (DC)

Others

Humidity (max): <=95% [at 60 deg C /140 F]
 Vibration: 15 g [10 Hz - 2000 Hz]
 Shock Resistance: 100 g [6 ms]
 Salt Spray Corrosion: >1000 hr
 Climatical Category: 50/175/21
 Shielding (min): 75 dB (10 MHz)
 Shielding (min): 40 dB (1 GHz)
 IP Rating: 50

DRAWINGS

Draws

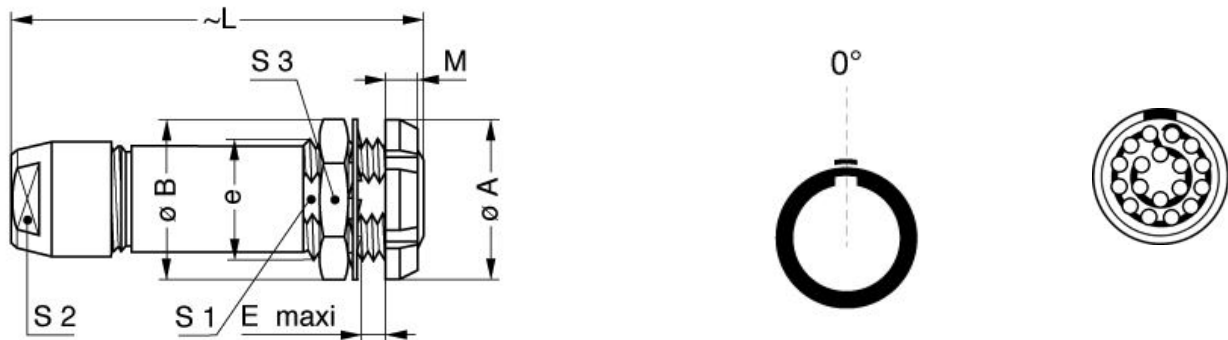

Dimensions

| | A | B | E | L | M | S1 | S2 | S3 | e |
|-----|------|------|------|------|------|------|------|------|---------|
| mm. | 20 | 20 | 6.5 | 47 | 3.5 | 13.5 | 12 | 17 | M15x1.0 |
| in. | 0,79 | 0,79 | 0,26 | 1,85 | 0,14 | 0,53 | 0,47 | 0,67 | |

LEMO products and services are provided "as is". LEMO makes no warranties or representations with regard to LEMO product & services or use of them, express, implied or statutory, including for accuracy, completeness, or security. The user is fully responsible for his products and applications using LEMO components.

RECOMMENDED BY LEMO

Tools

Crimp Tool: DPC.91.701.V

Crimp settings: AWG/Selector = 22-24-26/6-5-5

Positionner: DCE.91.072.BVM

Extractor: DCF.91.070.2LT

Replacement contact: EGG.2B.655.ZZM

Spanner wrench: MTZ.2B.220.120

Cables

| | | | |
|---------|-----|-------|---|
| 218 220 | PVC | Black |  |
| 218 240 | PVC | Black |  |
| 236 080 | PVC | Grey | |
| 318 250 | PVC | Grey |  |

LEMO products and services are provided "as is". LEMO makes no warranties or representations with regard to LEMO product & services or use of them, express, implied or statutory, including for accuracy, completeness, or security. The user is fully responsible for his products and applications using LEMO components.