

SUMMARY

Wires

Low	68
High	0
Coax	0
Triax	0
Quad	0
Fiber	0
Fluidic	0

Series	LM
Termination type	Male crimp
IP rating	68
Cable Ø	11.35 - 22.70 mm
Matching parts	HEW.LM.368.XLNP
Status	active
Alternative part	



Image is for illustrative purpose only

Download

[Request a quote](#)

[Catalog](#)

TECHNICAL DETAILS

Mechanics

Shell Style/Model	FM*: Straight plug, key (N) or keys (P, R, S, T, U, V, W and X) with knurled grip and mold stop
Keying	5 keys (alpha=95, beta=115, gamma=35, delta=25, plug: male contacts, receptacle: female contacts)
Housing Material	Environment friendly aluminium (nickel plated, anthracite color) shell and nut, other pieces bronze/brass
Cable Fixing	∅ 11.35 - 22.7 mm
Variant	
Weight	32.56 g

Performance

Configuration	
Insulator	
Rated Current	2.5 Amps

Specifications

LEMO products and services are provided "as is". LEMO makes no warranties or representations with regard to LEMO product & services or use of them, express, implied or statutory, including for accuracy, completeness, or security. The user is fully responsible for his products and applications using LEMO components.

Contact Type: Crimp
 Test voltage (kV rms) Contact-contact: 1.40
 Test voltage (kV rms) Contact-shell: 1.65

Others

Humidity (max): <=95% [at 60 deg C / 140 F]
 Vibration: 15 g [10 Hz - 2000 Hz]
 Shock Resistance: 100 g [6 ms]
 Operating temperature: -55° C/ +200° C
 Climatical Category: 15/200/21 (Al. shell)
 Lighting strike EIA 364-75 10K amps - 6 times
 EMI Shielding EIA 364-66A - 1Ghz-80 dB,3GHz-70 dB,6GHz- 58dB
 IP Rating: 68

DRAWINGS

Draws

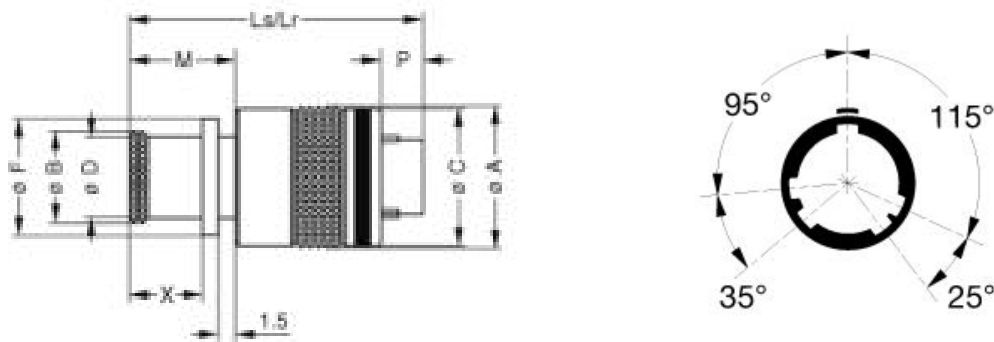

Dimensions

	A	B	C	D	F	Lr	Ls	M	P	X
mm.	28.5	23.9	28	22.7	25.8	31.6	31.6	10.6	3.4	7.6
in.	1,12	0,94	1,10	0,89	1,02	1,24	1,24	0,42	0,13	0,30

RECOMMENDED BY LEMO

Tools

Crimp Tool: DPC.91.701.V

LEMO products and services are provided "as is". LEMO makes no warranties or representations with regard to LEMO product & services or use of them, express, implied or statutory, including for accuracy, completeness, or security. The user is fully responsible for his products and applications using LEMO components.

Crimp settings: AWG/Selector = 28-30-32/4-3-3
Positionner: DCE.91.070.5MVC
Extractor: DCF.93.070.4LT
Replacement contact: FGN.0M.556.ZZC

Cables

LEMO products and services are provided "as is". LEMO makes no warranties or representations with regard to LEMO product & services or use of them, express, implied or statutory, including for accuracy, completeness, or security. The user is fully responsible for his products and applications using LEMO components.