

SUMMARY

Wires

| | |
|---------|---|
| Low | 0 |
| High | 0 |
| Coax | 0 |
| Triax | 1 |
| Quad | 0 |
| Fiber | 0 |
| Fluidic | 0 |



Image is for illustrative purpose only

Download

[Request a quote](#)

[Catalog](#)

| | |
|------------------|----------------|
| Series | 1E |
| Termination type | Male solder |
| IP rating | 68 |
| Cable Ø | 7.10 - 7.50 mm |
| Matching parts | ERA.1E.650.CLL |
| Status | active |
| Alternative part | |

TECHNICAL DETAILS

Mechanics

| | |
|-------------------|---|
| Shell Style/Model | FFA*: Straight plug with oversize cable collet and nut for fitting a bend relief |
| Keying | Circular (can rotate), plug has male contact(s) |
| Housing Material | Brass (chrome plated) shell and collet nut, nickel plated brass latch sleeve and mid pieces |
| Cable Fixing | K75: 7.1 - 7.5 mm |
| Variant | Z : Nut for fitting a bend relief |
| Weight | 34.26 g |

Performance

| | |
|---------------|---------------------------|
| Configuration | 1E.650 : 1 Triax (50 Ohm) |
| Insulator | T: PTFE |
| Rated Current | 6 Amps |

Specifications

Contact Type: Solder
Vtest: 1200 V (AC), 1690 V (DC)

LEMO products and services are provided "as is". LEMO makes no warranties or representations with regard to LEMO product & services or use of them, express, implied or statutory, including for accuracy, completeness, or security. The user is fully responsible for his products and applications using LEMO components.

Impedance: 50 Ohm
VSWR: $1.01 + 0.17 * f/\text{GHz}$
Cable type: RGT 178, RGT 174, Belden 9222

Others

Endurance (Shell): 5000 mating cycles
Temp (min / max): $-55^{\circ}\text{C} / +200^{\circ}\text{C}$
Humidity (max): $\leq 95\%$ [at 60 deg C / 140 F]
Vibration: 15 g [10 Hz - 2000 Hz]
Shock Resistance: 100 g [6 ms]
Salt Spray Corrosion: >1000 hr
Climatical Category: 50/175/21
Shielding (min): 95 dB (10 MHz)
Shielding (min): 80 dB (1 GHz)
IP Rating: 68

DRAWINGS

Draws

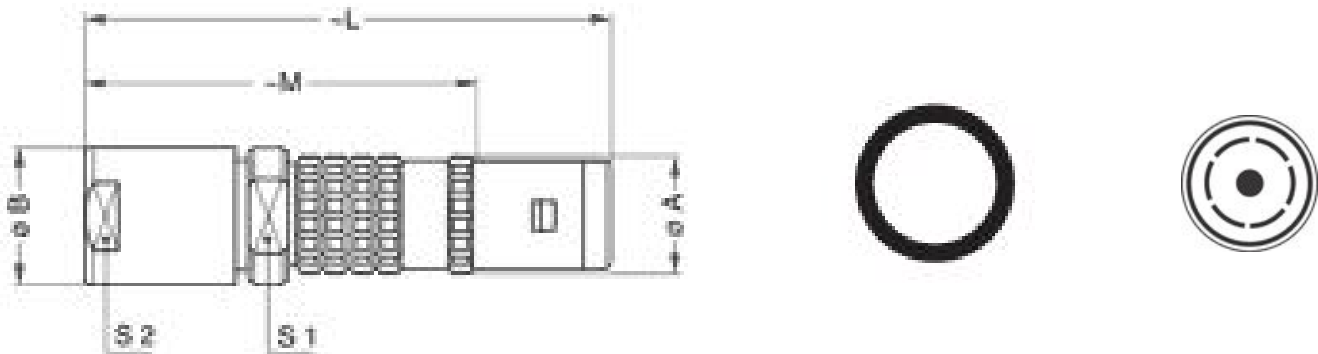

Dimensions

| | A | L | M | S2 |
|-----|------|------|------|------|
| mm. | 13 | 42 | 28 | 9 |
| in. | 0,51 | 1,65 | 1,10 | 0,35 |

RECOMMENDED BY LEMO

Tools

LEMO products and services are provided "as is". LEMO makes no warranties or representations with regard to LEMO product & services or use of them, express, implied or statutory, including for accuracy, completeness, or security. The user is fully responsible for his products and applications using LEMO components.

Spanner wrench: DCD.1E.008.PA090
Caps: BFA.1E.100.NAS

Cables

LEMO products and services are provided "as is". LEMO makes no warranties or representations with regard to LEMO product & services or use of them, express, implied or statutory, including for accuracy, completeness, or security. The user is fully responsible for his products and applications using LEMO components.