

1

2

3

4

5

6

7

Dim A=2,54xNo. of Positions±0,40

Dim B=2,54xNo. of Contacts-2,54±0,20④

2,54±0,10

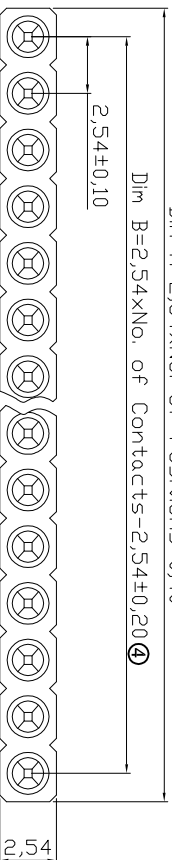

Technical Data

Material:

Pin(outer sleeve): Brass, machined, CuZn38Pb2

④ Clip(contact 4 finger): Beryllium copper, heat treated

Plating Pin(outer sleeve): 2um/80u" nickel, 5um/200u" Tin

Plating Clip(contact 4 finger): 2um/80u" nickel, Gold flash

④ Insulator body(housing): PPS UL94V-0 Black

Electrical

Current rating: 3 Amps/contact max.

Contact resistance: $\leq 4m\Omega$ /contact

Insulation resistance: $\geq 10000M\Omega$ at 500VAC

Voltage rating: 100V/RMS/150VDC

Mechanical

Average insertion force with steel pin of

$\varnothing 0,43mm/0,017''$: <250g

Average withdrawal force with steel pin of

$\varnothing 0,43mm/0,017''$: >50g

Mechanical life cycle: min. 200

Operating temperature: -40°C to +105°C

Soldering temperature: +260°C, 10s max.

Package: PE bag

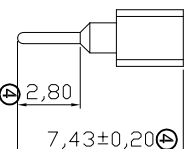
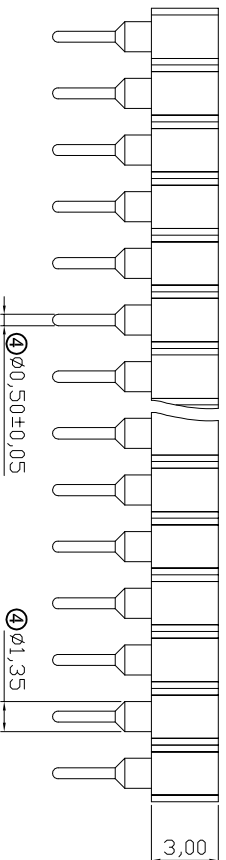

Contact	Dim A	Dim B	Contact	Dim A	Dim B	Contact	Dim A	Dim B
01	2,54	—	15	38,10	35,56	29	73,66	71,12
02	5,08	2,54	16	40,64	38,10	30	76,20	73,66
03	7,62	5,08	17	43,18	40,64	31	78,74	76,20
04	10,16	7,62	18	45,72	43,18	32	81,28	78,74
05	12,70	10,16	19	48,26	45,72	33	83,82	81,28
06	15,24	12,70	20	50,80	48,26	34	86,36	83,82
07	17,78	15,24	21	53,34	50,80	35	88,90	86,36
08	20,32	17,78	22	55,88	53,34	36	91,44	88,90
09	22,86	20,32	23	58,42	55,88	37	93,98	91,44
10	25,40	22,86	24	60,96	58,42	38	96,52	93,98
11	27,94	25,40	25	63,50	60,96	39	99,06	96,52
12	30,48	27,94	26	66,04	63,50	40	101,60	99,06
13	33,02	30,48	27	68,58	66,04			
14	35,56	33,02	28	71,12	68,58			

Dim B=2,54xNo. of Contacts-2,54±0,20

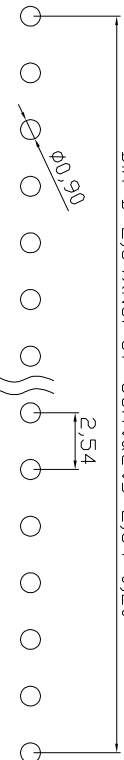

P.C.B. LAYOUT

ROHS compliant

Unit: mm

Scale Free

TOLERANCE

X. ±0.50

X.X ±0.30

X.XX ±0.20

DIM TOL

Angle ±5°

Angle

Angle

Scale	Free
TOLERANCE	
X.	±0.50
X.X	±0.30
X.XX	±0.20
DIM	TOL
Angle	±5°
Angle	
Angle	

Update to new drawing

P/N corrected

Update

Drawn

Id.

Modification

Date

Name

Date

Name

Date

Name

Date

Name

Date

Name

Date

Name

Date

Name

Date

Name

Date

Name

Customer-No.

ASSMANN WSW-No.

AW 127-XX/Z-T

Drawing-No.

ASS 0212 CO

Replace

Sheet

rev04

Sheet

Sheet

Sheet

Sheet

1

2

3

4

5

6

7

SV313