

1

2

3

4

5

6

7

Male

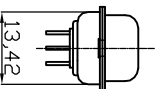
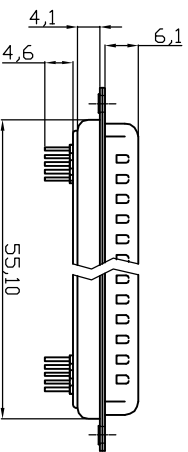
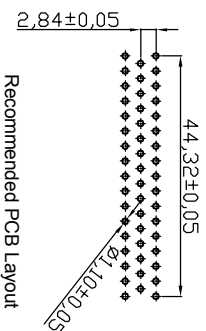
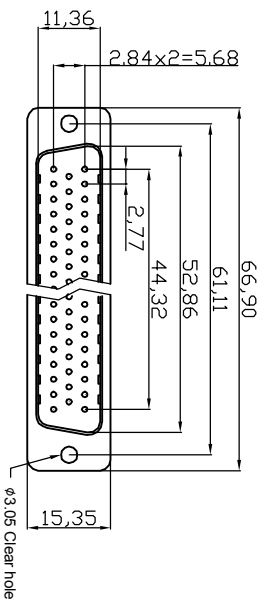
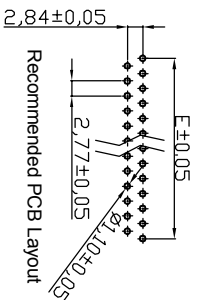
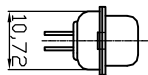
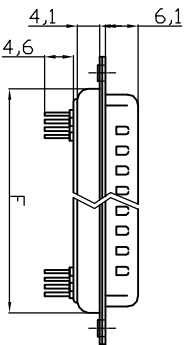
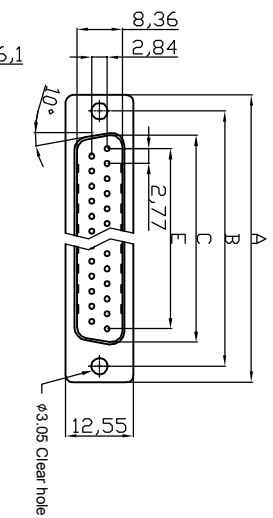

50 Positions

Positions	A	B	C	E	F
09	30.81	24.99	16.92	11.08	19.20
15	39.20	33.30	25.25	19.39	27.70
25	53.04	47.04	38.96	33.24	41.10
37	69.40	63.50	55.42	49.86	57.30

Dimensions

- NOTES:**
- MATERIAL**
1. Insulator Material: Glass-filled thermoplastic PBT, UL94V-0
 2. Contact Material: Brass or Phosphor Bronze
 3. Shell : Steel, 100 µ" Tin Over 50µ" min Copper
 4. Clinch Nut : Brass,Nickel Plated
 - 5 Contact plating : Gold flash full gold &selective 15u"Au ELECTRICAL
1. Current Rating : 3AMP
 2. Voltage Rating : 250V AC/rms 60Hz
 3. Contact Resistance: 20mΩ
 4. Insulation Resistance: 1000MΩ, min at 500 VDC.
 5. Withstand Voltage: 1000V AC/rms 60Hz for 1 minute ENVIRONMENTAL
1. Temperature Range: -20°C~+105°C
 2. UL No. E198287
 3. Order Code: A-Dx xx PP/Z-X
- Contact style:
 F Female
 S - Male
 No. of Contacts
 09 / 15 / 25 / 37
 Standard: Quality class III

RoHS compliant

Unit:mm

Scale	Free	⑤	⑤	⑤	⑤
TOLERANCE		Add the contact plating 15u"Au	01.09.2017	Winnie	Date
X.	±0.38	④ Add the detail contact plating	23.12.2016	Winnie	Name
X.X	±0.25	③ Update the dimension	27.02.2015	Winnie	Drawn
X.XX	±0.13	② Update the operating temperature&UL No.	04.08.2014	Winnie	Approved
DIM	TOL	① Update	24.10.2012	Winnie	Winnie
X.°	±3°	① Drawn	15.08.2012	Lucas	Lucas
X.X°	±1.0°	Id:			
Angle	TOL	Modification			



Customer-No.
 ASSMANN WSW-No.
A-DX XX PP/Z-X

Drawing-No.
ASS 4885 CO

rev05

Replace

Sheet 1/2

1

2

3

4

5

6

7

H

G

F

E

D

C

B

A

1

2

3

4

5

6

7

Female

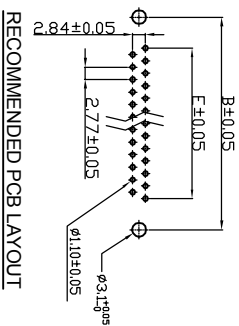
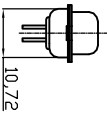
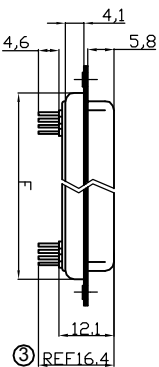
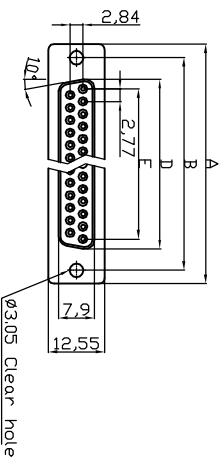

- NOTES:**
- MATERIAL**
1. Insulator Material: Glass-filled thermoplastic PBT, UL 94V-0, Gray
 2. Contact Material: Copper alloy
 3. Shell: Steel, 100 μ" Tin Over 50μ" min Copper
 4. Clinch Nut: Brass, Nickel Plated
 5. Contact plating: Gold flash full gold
- ELECTRICAL**
1. Current Rating : 3AMP
 2. Voltage Rating : 250V AC/rms 60Hz
 3. Contact Resistance: 20mΩ Max at 1 AMP DC
 4. Insulation Resistance: 1000MΩ at 500 VDC
 5. Withstand Voltage: 1000V AC/rms 60Hz for 1 minute
 6. OPERATING TEMPERATURE: -20°C+105°C

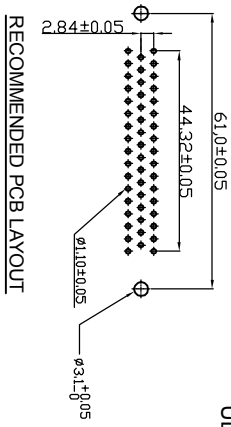
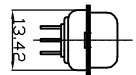
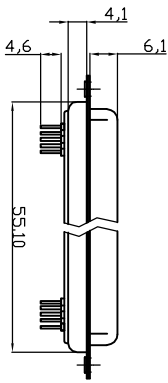
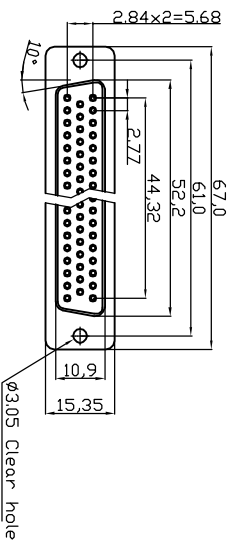

Dimensions

Positions	A±0.15	B±0.10	D±0.13	E±0.08	F±0.10
09	30.81	24.99	16.33	11.08	19.20
15	39.20	33.30	24.70	19.39	27.70
25	53.05	47.04	38.40	33.24	41.10
37	69.40	63.50	54.80	49.86	57.30

50 POSITIONS

RoHS compliant
Unit: mm

Scale	Free	⑤ Add the contact plating 15u" Au	01.09.2017	Winnie
TOLERANCE		④ Add the clinch nut & plating	23.12.2016	Winnie
X.	±0.38	③ Update the dimension.	27.02.2016	Winnie
X.X	±0.25	② Update the operating temperature & UL No	04.08.2014	Winnie
X.XX	±0.13	① Update	24.10.2012	Winnie
DIM	TOL	① Drawn	15.08.2012	Lucas
X.°	±3°			
X.X°	±1.0°			
Angle	TOL	Id:	Date	Name
		Modification		

Customer-No.

ASSMANN WSW-No.

A-DX XX PP/Z-X

Drawing-No.

ASS 4885 CO

rev05

Replace

Sheet 2/2

1

2

3

4

5

6

7

H

G

F

E

D

C

B

A