

9000 series

Subminiature momentary pushbutton switches

Distinctive features and specifications

UG1410A



- Panel and PC mount models, horizontal or vertical
- Self-cleaning and butt action contacts
- Several plunger options

B2

ELECTRICAL SPECIFICATIONS

- Max. current/voltage rating with resistive load : 100mA 30VDC
- Initial contact resistance : 30 mΩ max.
- Insulation resistance : 1.000 MΩ min. at 500VDC
- Dielectric strength :
 - 500 Vrms 50 Hz min. between terminals
 - 1.000 Vrms 50 Hz min. between terminals and frame
- Electrical life at full load :
 - 9100 - 9200N and 9500N : 250.000 cycles
 - 9200 - 9500 : 100.000 cycles

MATERIALS

- Case : Pa6T
- Actuator : polyamide, glass filled
- Bushing : brass, nickel plated
- Contacts :
 - CD : brass, gold plated
- Terminal seal : epoxy

GENERAL SPECIFICATIONS

- Torque : 0,5 Nm (.590 Ft.lb) max. applied to nut
- Operating temperature : -30°C to +65°C
- Panel thickness : 1,50 mm (.059) max.
- Travels : see table below
 - Tolerance : +/- 0,3 mm (.011)

	9533-9233	9532-9232	9533N 9233N-9133
Total travel	1,10 (.043)	1,80 (.070)	1 (.039)
Pre-travel	0,80 (.031)	1,00 (.039)	-
Over travel	0,30 (.011)	0,75 (.029)	-

The company reserves the right to change specifications without notice.

9000 series

Subminiature momentary pushbutton switches

Overview

B2

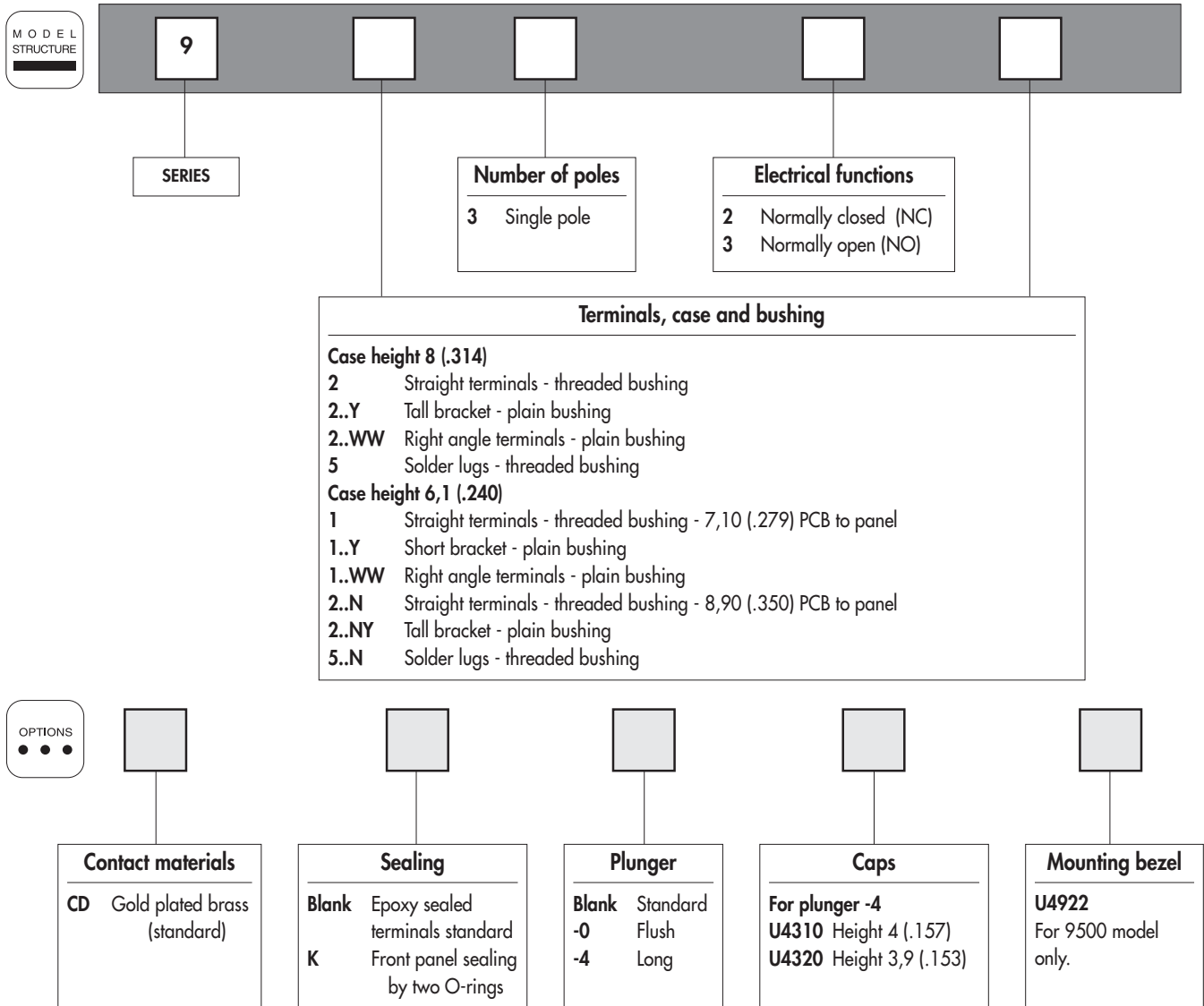

ABOUT THIS SERIES

On the following pages, you will find successively :

- model structure of switches
- their options in the same order as in above chart

Dimensions : first dimensions are in mm while inches are shown as bracketed numbers.



NOTICE : please note that not all combinations of above numbers are available. Refer to the following pages for further information.



Sealing boots are available to protect the switches. They are presented in section H.



Mounting accessories : standard hardware supplied with all threaded bushing models : 1 nickel plated hex nut 5 (.196) across flats, part number U544. This nut is presented after model structure of switches.



Packaging unit : 100 pieces.

9000 series

Subminiature momentary pushbutton switches

Solder lug or straight PC terminals : 9500 - 9200 - 9200Y

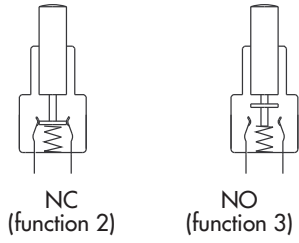
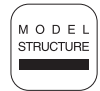

- Case height 8 (.314)
- With over travel
- Self-cleaning contacts
- Epoxy sealed terminals standard

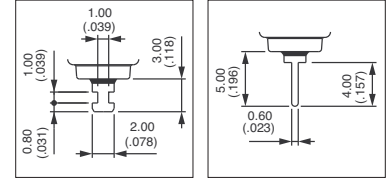

MODEL STRUCTURE

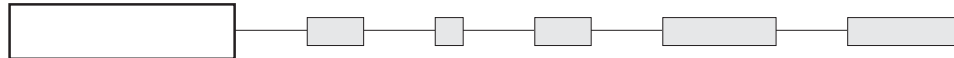

B2

Threaded bushing - solder lugs : 9500



9532

Normally Closed

9533

Normally Open

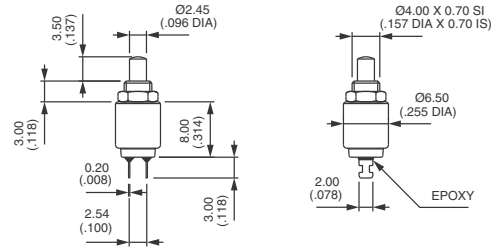

Threaded bushing - straight PC terminals : 9200



9232

Normally Closed

9233

Normally Open

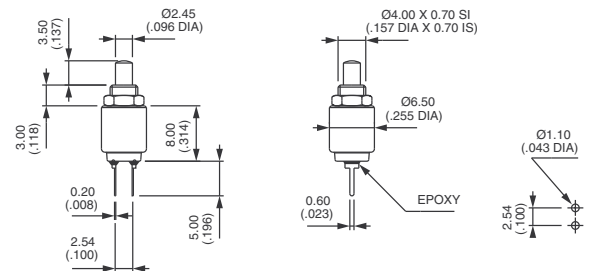

Straight PC terminals - bracket mounting : 9200Y



9232Y

Normally Closed

9233Y

Normally Open

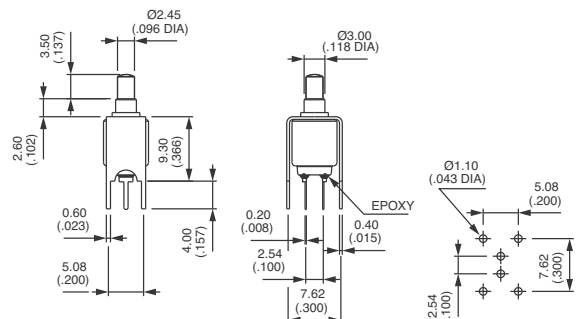



9000 series

Subminiature momentary pushbutton switches

Right angle terminals : 9200WW

Right angle terminals : 9200WW



9232WW

Normally Closed

9233WW

Normally Open

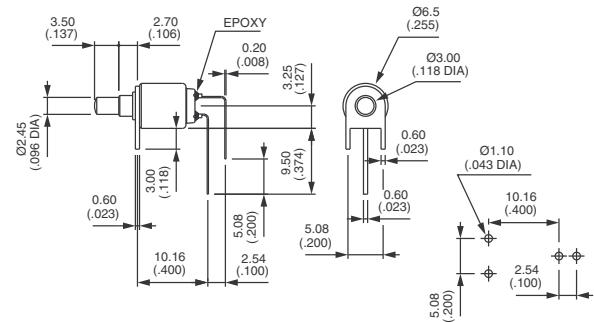

PANEL CUT-OUT

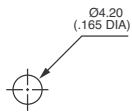

For threaded bushing models.

STANDARD HARDWARE

9500 - 9200

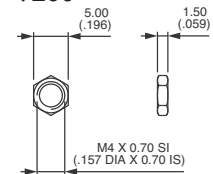

U544 (nickel plated)

B2

9000 series

Subminiature momentary pushbutton switches

Solder lug or straight PC terminals : 9500N - 9200N - 9100

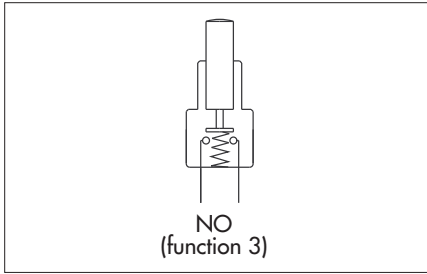

- Case height 6,1 (.240)
- Epoxy sealed terminals
- Butt action contacts

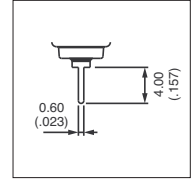
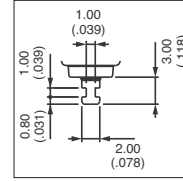

MODEL
STRUCTURE

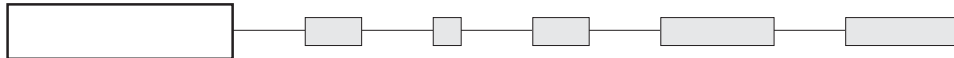

B2

Threaded bushing - solder lugs : 9500N



9533N



Normally Open

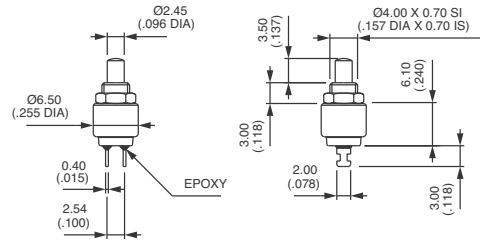

Threaded bushing - straight PC terminals - 8,90 (.350) PCB to panel



9233N



Normally Open

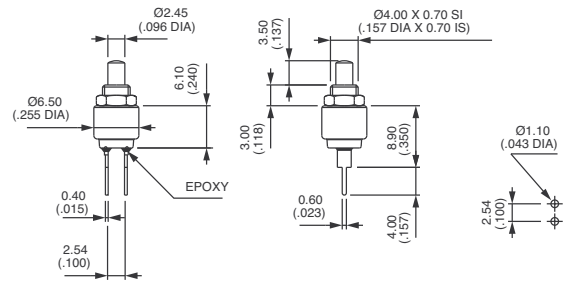

Threaded bushing - straight PC terminals - 7,10 (.279) PCB to panel



9133



Normally Open

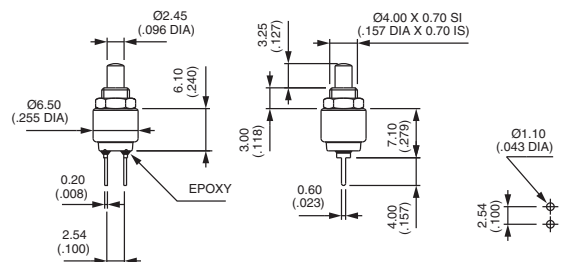



9000 series

Subminiature momentary pushbutton switches

Straight PC or right angle terminals : 9200NY - 9100Y - 9100WW

Straight PC terminals - tall bracket : 9200NY



9233NY



Normally Open

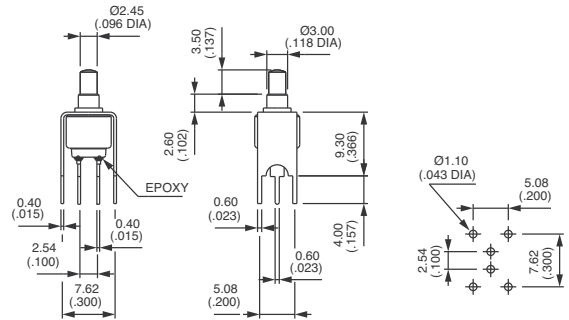

Straight PC terminals - short bracket : 9100Y



9133Y



Normally Open

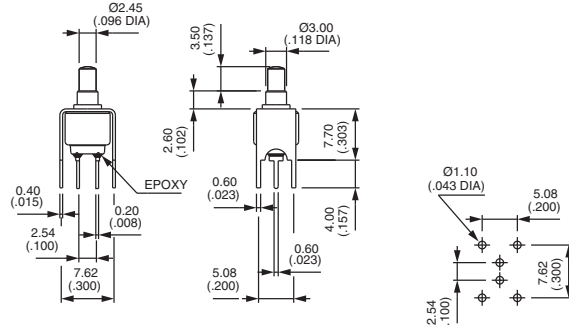

Right angle terminals - vertical : 9100WW



9133WW



Normally Open

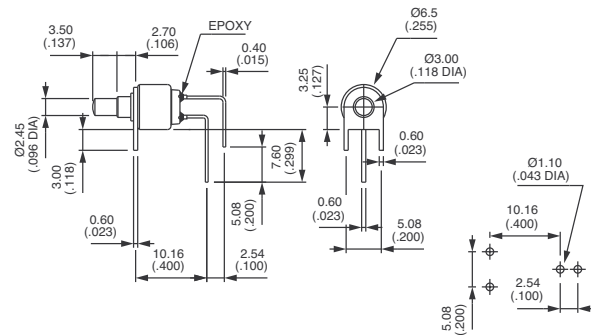

PANEL CUT-OUT

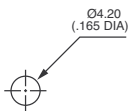

For threaded bushing models.

STANDARD HARDWARE

9500N - 9200N - 9100

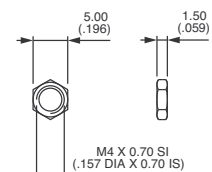

M4 X 0.70 SI (.157 DIA X 0.70 IS)

U544 (nickel plated)

9000 series

Subminiature momentary pushbutton switches



CONTACT MATERIALS

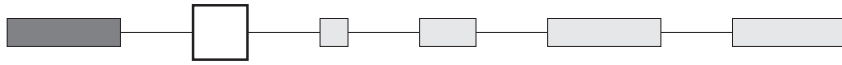

CD Gold plated brass (standard)

SEALING

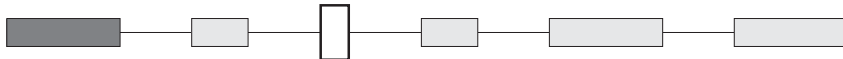

Blank Epoxy sealed terminals standard

K Front panel sealing by two O-rings. Protects the switch against water and dust. Panel seal withstands 0,1 bar pressure.



Option K for models 9533N, 9233N and 9133 only.

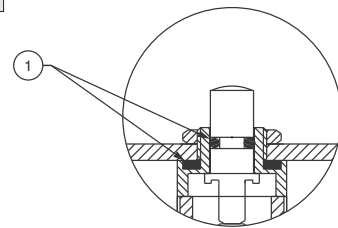

① O-rings

PLUNGERS

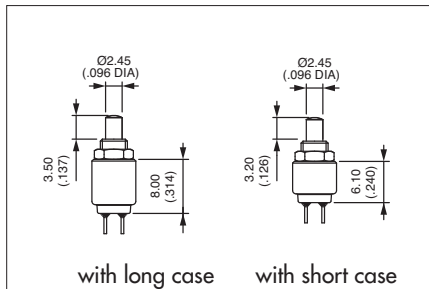

Standard

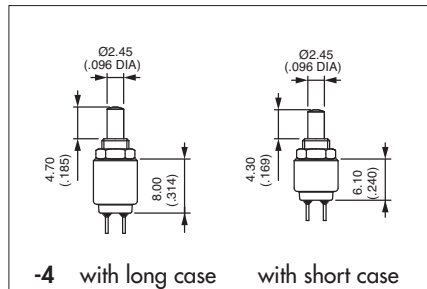

Long

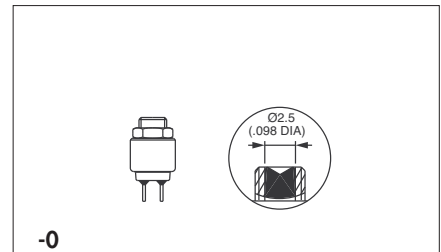

-0

Flush

B2



9000 series

Subminiature momentary pushbutton switches

CAPS

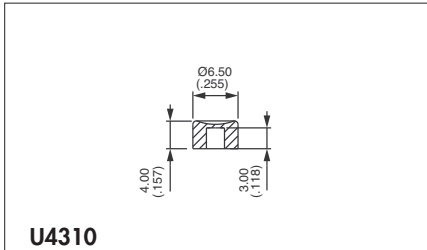
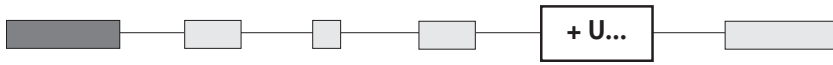

U4310

For use with plunger -4 only

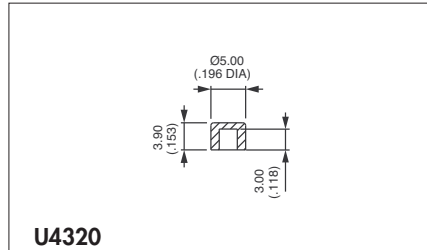

U4320

For use with plunger -4 only

Cap colours	
Replace "0" by number	
1	blue
1/4	dark blue
2	black
3	green
4	grey
5	yellow
6	red
7	ivory
7/1	white
9	orange

MOUNTING BEZEL

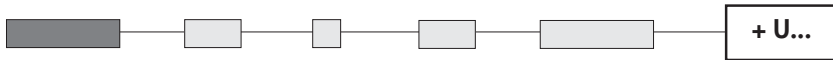

For 9500 model (case height 8 mm) only

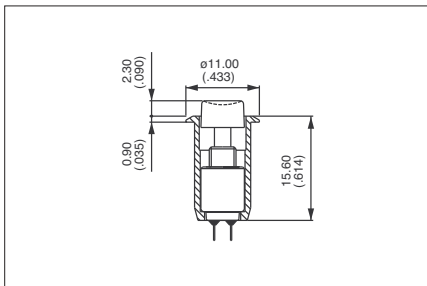

Shown with cap U570.

The mounting bezel U4922 has been designed to facilitate the mounting of the 9500 series pushbutton switch onto a panel. The switch + bezel assembly is snapped into the equipment through the front of the panel, then electrically connected by solder lug terminals.
 Panel cut-out : $\varnothing 8,15 \text{ mm} \pm 0,05$
 (.320 DIA $\pm .002$)