

PART NUMBER  
SEE NOTE 6

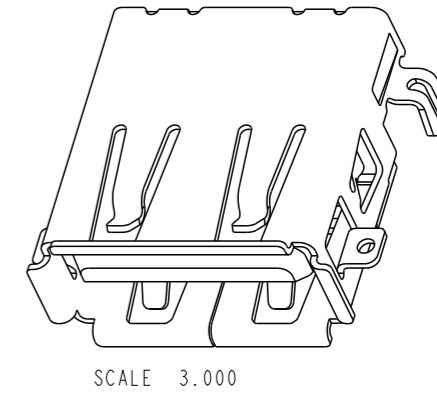

SCALE  
3.000  
RECOMMENDED PCB LAYOUT  
TOLERANCE ±0.05

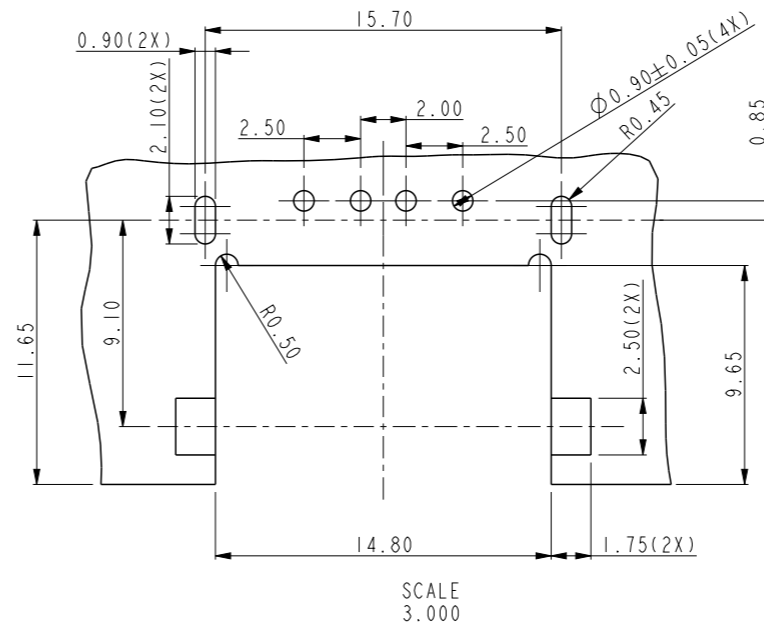
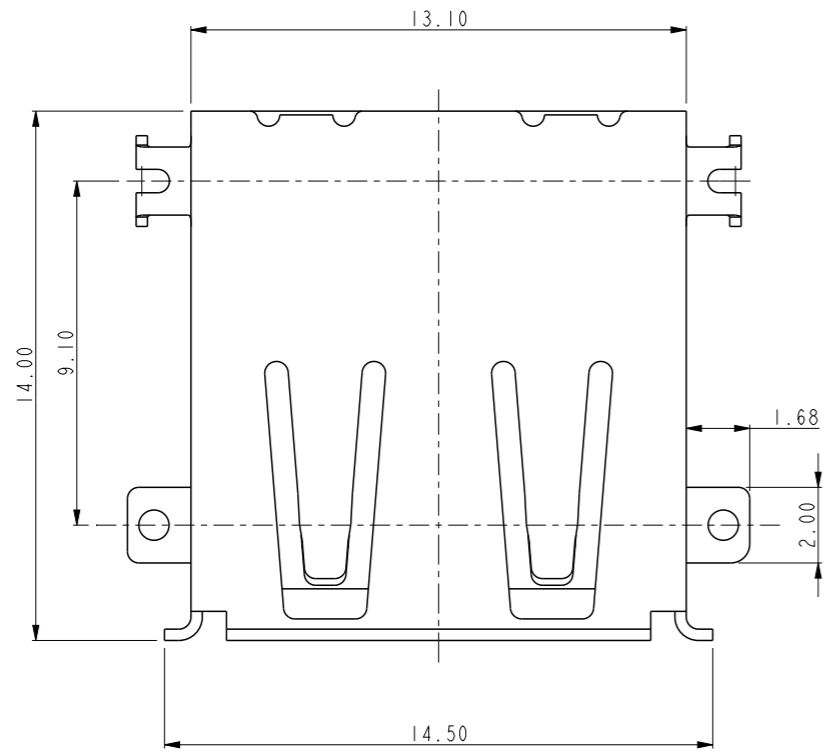
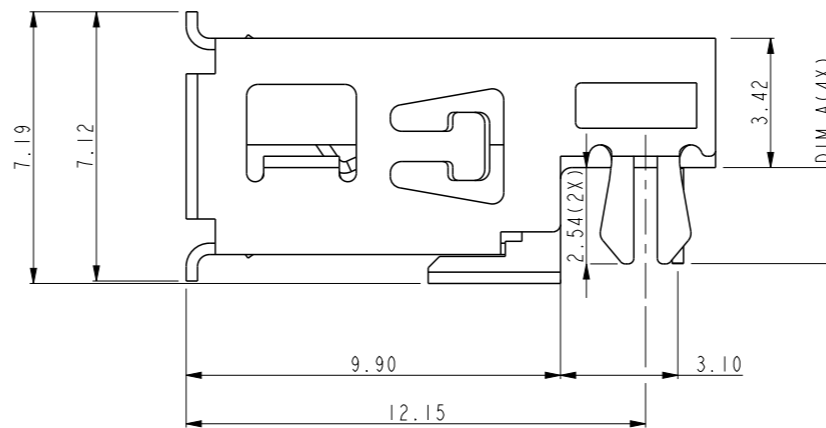
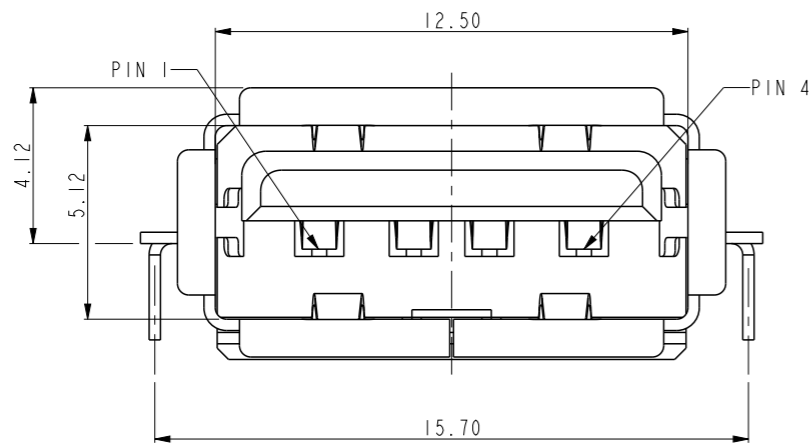

NOTES:

- MATERIAL:
  - HOUSING: HIGH TEMPERATURE THERMOPLASTIC, UL94V-0, COLOR: SEE NOTE 6.
  - TERMINAL: COPPER ALLOY.
  - SHELL: COPPER ALLOY.
- FINISH:
  - TERMINAL: 30u" GXT/Au ON CONTACT AREA, 100u" MATTE TIN ON SOLDER TAIL, UNDER PLATING: 50u" Ni MIN. OVER ALL.
  - SHELL: MATTE TIN OVER 50u" Ni OVER ALL, 100u" MATTE TIN MIN ON SOLDER TAIL OVER 50u" Ni.
- THIS PRODUCT WILL WITHSTAND EXPOSURE TO 260°C PEAK TEMPERATURE FOR 20 SECONDS IN A CONVECTION, INFRA-RED OR VAPOR PHASE REFLOW OVEN;
- FOR LEAD FREE P/N, THE PRODUCT MEET EUROPEAN UNION DIRECTIVES AND OTHER COUNTRY REGULATION AS DESCRIBED IN GS-22-008.
- THE PRODUCT CAN BE USED FOR PIP PROCESS.
- PART NUMBER DEFINITION:  
10130976 - X X X X LF

- LEAD FREE
- PACKING TYPE  
B: TUBE
- DIM A  
1: DIM A=2.54 FOR PCB THICKNESS: 1.6mm  
2: DIM A=2.00 FOR PCB THICKNESS: 1.2mm
- COLOR OF HOUSING  
0: BLACK  
1: YELLOW
- PLATING CODE  
1: 30u" GXT ON CONTACT AREA  
2: 30u" Au ON CONTACT AREA  
3: 15u" GXT ON CONTACT AREA



Copyright FCI.

spec ref	-	dr	Li-Qing Lei	2014/08/05	projection	MM	size	A3	scale	5.000
tolerance std	ISO 406 ISO 1101	eng	Li-Qing Lei	2014/08/06			ecn no	-	rel level	Released
TOLERANCES UNLESS OTHERWISE SPECIFIED		chr	-	-			product family	-	rel level	Released
surface	ISO 1302	appr	Rick Bian	2014/08/06			dwg no	10130976	rev	A
	linear	0.X	±0.3		<b>USB 2.0 A TYPE RECEPTACLE</b> OFFSET TYPE		Product - Customer Drw		sheet 1 of 1	
		0.XX	±0.20		cat. no.	-				
	angular	0°	±2°							