

MAC210A8, MAC210A10

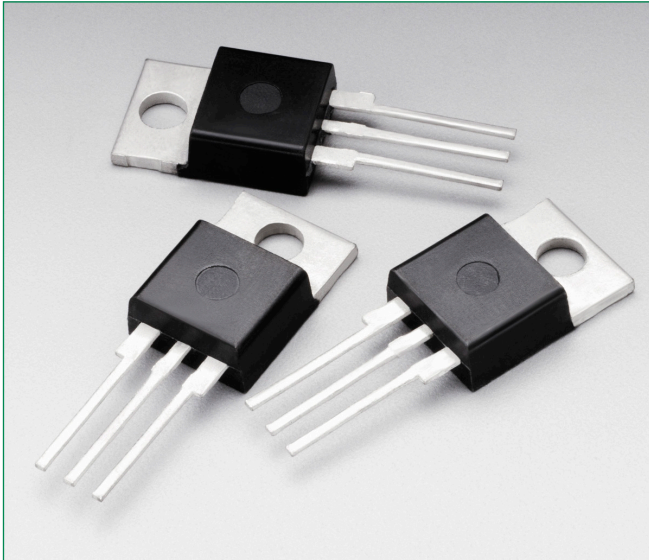

Description

Designed primarily for full-wave AC control applications, such as light dimmers, motor controls, heating controls and power supplies; or wherever full-wave silicon gate controlled solid-state devices are needed. Triac type thyristors switch from a blocking to a conducting state for either polarity of applied main terminal voltage with positive or negative gate triggering.

Features

- Blocking Voltage to 600 Volts
- All Diffused and Glass Passivated Junctions for Greater Parameter Uniformity and Stability
- Small, Rugged, Thermowatt Construction for Low Thermal Resistance, High Heat Dissipation and Durability
- Gate Triggering Guaranteed in Four Modes (Quadrants)
- Pb-Free Packages are Available

Pin Out

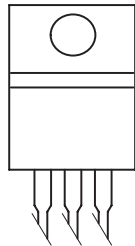
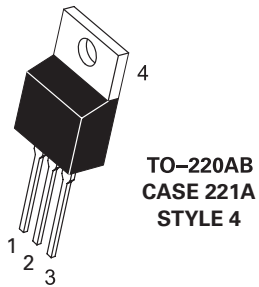

Functional Diagram

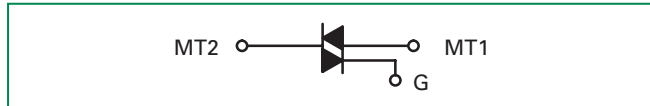

Additional Information



[Datasheet](#)



[Resources](#)



[Samples](#)

Maximum Ratings ($T_J = 25^\circ\text{C}$ unless otherwise noted)

Rating	Symbol	Value	Unit
Peak Repetitive Off-State Voltage (Note 1) (– 40 to 125°C, Sine Wave, 50 to 60 Hz, Gate Open)	V_{DRM} V_{RRM}	600 800	V
	MAC210A8 MAC210A10		
On-State RMS Current (Full Cycle Sine Wave, 50 to 60 Hz, $T_C = 70^\circ\text{C}$)	$I_{\text{T (RMS)}}$	10	A
Peak Non-Repetitive Surge Current (One Full Cycle Sine Wave, 60 Hz, $T_C = +25^\circ\text{C}$) Preceded and followed by rated current	I_{TSM}	100	A
Circuit Fusing Consideration ($t = 8.3$ ms)	I^2t	40	A ² sec
Peak Gate Power ($T_C = +80^\circ\text{C}$, Pulse Width = 1.0 μs)	P_{GM}	20	W
Average Gate Power ($t = 8.3$ ms, $T_C = 80^\circ\text{C}$)	$P_{\text{G (AV)}}$	0.35	W
Peak Gate Current ($T_C = +70^\circ\text{C}$, Pulse Width = 10 s)	I_{GM}	2.0	A
Operating Junction Temperature Range	T_J	-40 to +125	$^\circ\text{C}$
Storage Temperature Range	T_{stg}	-40 to +150	$^\circ\text{C}$

Maximum ratings are those values beyond which device damage can occur. Maximum ratings applied to the device are individual stress limit values (not normal operating conditions) and are not valid simultaneously. If these limits are exceeded, device functional operation is not implied, damage may occur and reliability may be affected.

- V_{DRM} and V_{RRM} for all types can be applied on a continuous basis. Ratings apply for zero or negative gate voltage; however, positive gate voltage shall not be applied concurrent with negative potential on the anode. Blocking voltages shall not be tested with a constant current source such that the voltage ratings of the devices are exceeded.

Thermal Characteristics

Rating	Symbol	Value	Unit
Thermal Resistance, Junction-to-Case (AC)	$R_{\text{θJC}}$	2.0	$^\circ\text{C/W}$
Junction-to-Ambient	$R_{\text{θJA}}$	62.5	
Maximum Lead Temperature for Soldering Purposes, 1/8" from case for 10 seconds	T_L	260	$^\circ\text{C}$

Electrical Characteristics - OFF ($T_J = 25^\circ\text{C}$ unless otherwise noted ; Electricals apply in both directions)

Characteristic		Symbol	Min	Typ	Max	Unit
Peak Repetitive Blocking Current ($V_D = V_{DRM} = V_{RRM}$; Gate Open)	$T_J = 25^\circ\text{C}$	I_{DRM}	-	-	10	μA
	$T_J = 125^\circ\text{C}$	I_{RRM}	-	-	2.0	mA

Electrical Characteristics - ON ($T_J = 25^\circ\text{C}$ unless otherwise noted; Electricals apply in both directions)

Characteristic		Symbol	Min	Typ	Max	Unit
Peak On-State Voltage (TM = 14 A Peak; Pulse Width = 1 to 2 ms, Duty Cycle 2%)		V_{TM}	-	-	1.6	V
Gate Trigger Current (Continuous dc) ($V_D = 12\text{ V}$, $R_L = 100\ \Omega$)	MT2(+), G(+)	I_{GT}	-	12	50	mA
	MT2(+), G(-)		-	12	50	
	MT2(-), G(-)		-	20	50	
	MT2(-), G(+)		-	35	75	
Gate Trigger Voltage (Continuous dc) ($V_D = 12\text{ V}$, $R_L = 100\ \Omega$)	MT2(+), G(+)	V_{GT}	-	0.9	2.0	V
	MT2(+), G(-)		-	0.9	2.0	
	MT2(-), G(-)		-	1.1	2.0	
	MT2(-), G(+)		-	1.4	2.5	
Holding Current ($V_D = 12\text{ V}_{dc}$, Gate Open, Initiating Current = $\pm 150\text{ mA}$)		I_H	-	6.0	50	mA
Turn-On Time (Rated V_{DRM} , $I_{TM} = 14\text{ A}$) ($I_{GT} = 120\text{ mA}$, Rise Time = 0.1 s, Pulse Width = 2 s)		t_{gt}	-	1.5	-	μs

Dynamic Characteristics

Characteristic	Symbol	Min	Typ	Max	Unit
Critical Rate of Rise of Commutation Voltage ($V_D = \text{Rated } V_{DRM}$, $I_{TM} = 14\text{ A}$, Commutating $di/dt = 5.0\text{ A/ms}$, Gate Unenergized, $T_C = 70^\circ\text{C}$)	$(di/dt)_c$	-	5.0	-	A/ms
Critical Rate of Rise of Off-State Voltage ($V_D = \text{Rated } V_{DRM}$, Exponential Waveform, Gate Open, $T_C = +70^\circ\text{C}$)	dv/dt	-	100	-	V/ μs

Voltage Current Characteristic of SCR

Symbol	Parameter
V_{DRM}	Peak Repetitive Forward Off State Voltage
I_{DRM}	Peak Forward Blocking Current
V_{RRM}	Peak Repetitive Reverse Off State Voltage
I_{RRM}	Peak Reverse Blocking Current
V_{TM}	Maximum On State Voltage
I_H	Holding Current

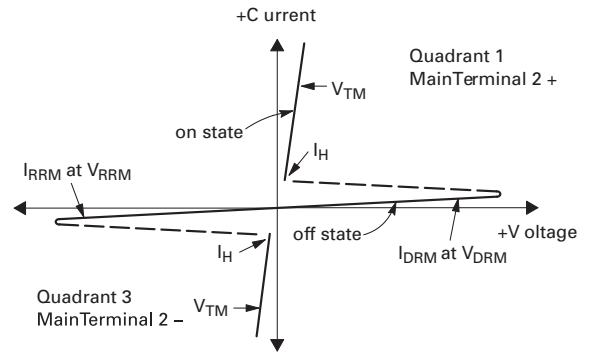

Quadrant Definitions for a Triac

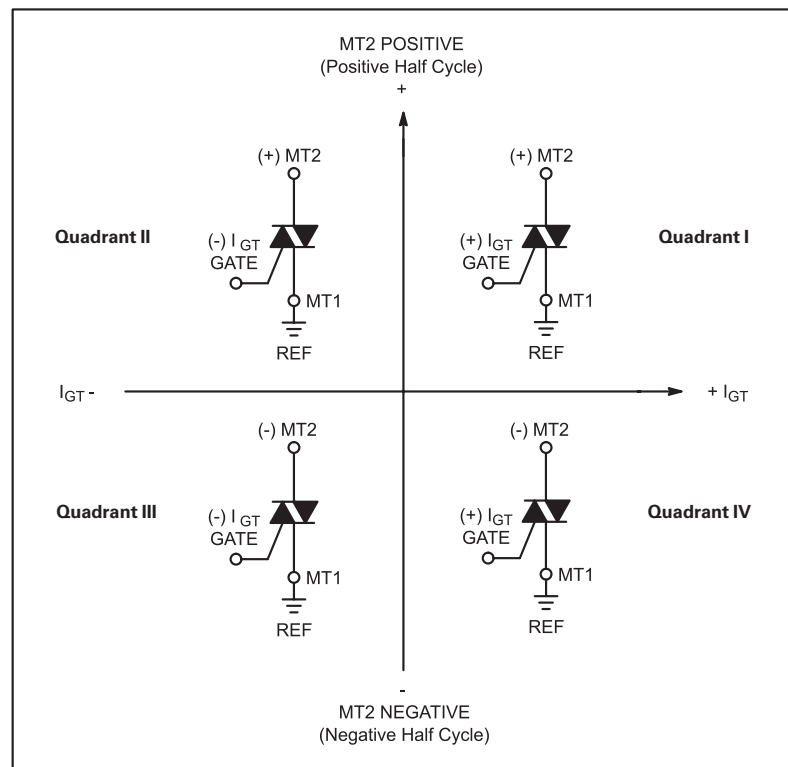

All polarities are referenced to MT1.

With in-phase signals (using standard AC lines) quadrants I and III are used.

Figure 1. Current Derating

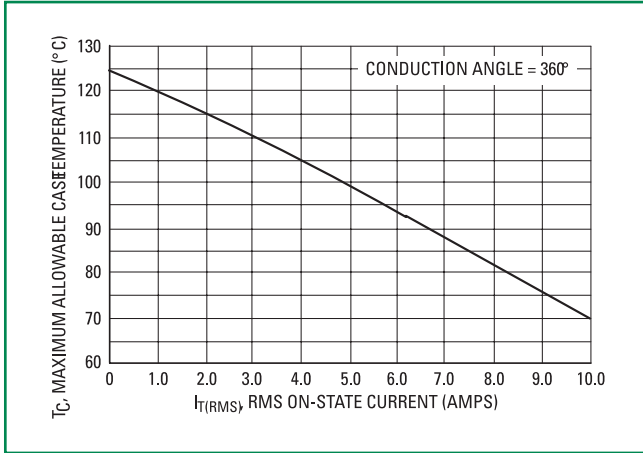

Figure 2. Power Dissipation

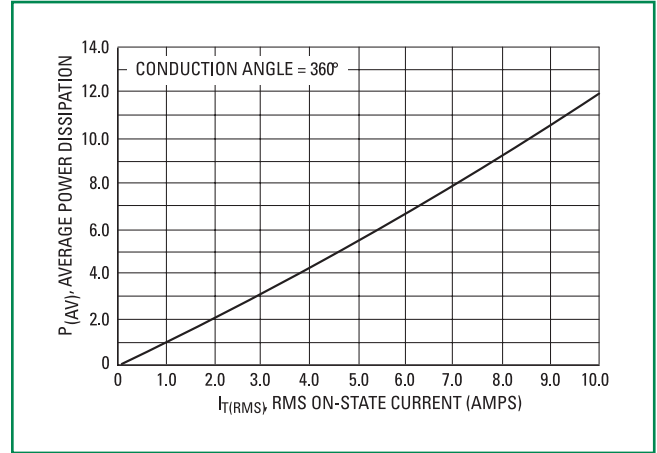

Figure 3. Maximum On-State Characteristics

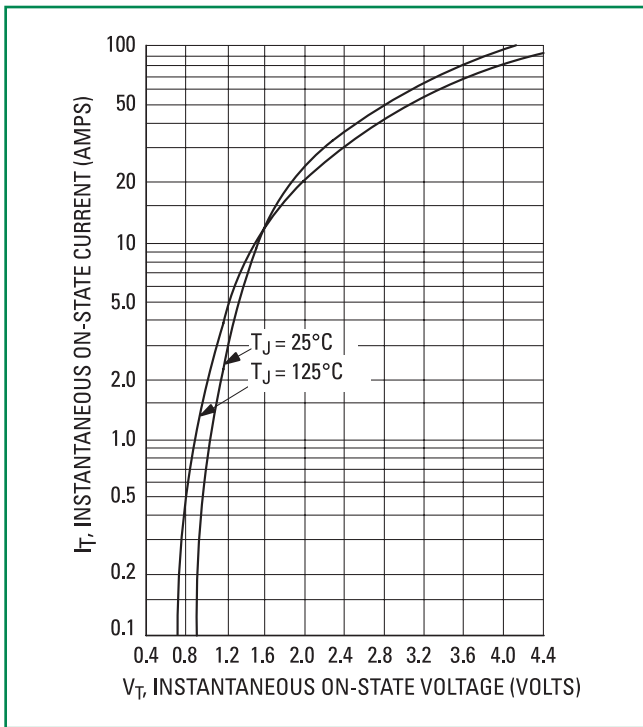

Figure 4. Maximum Non-Repetitive Surge Current

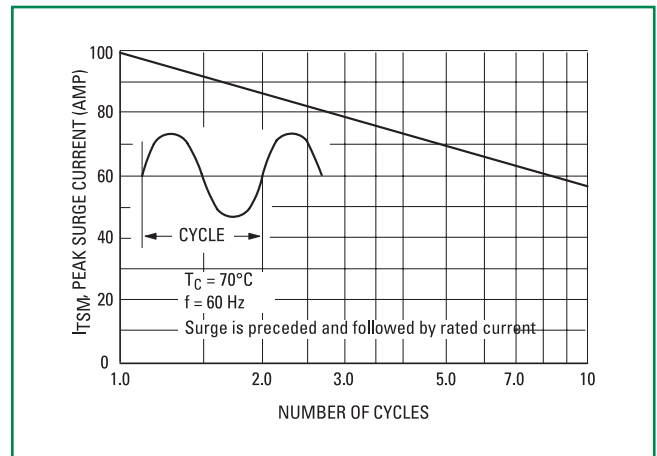

Figure 5. Typical Gate Trigger Voltage

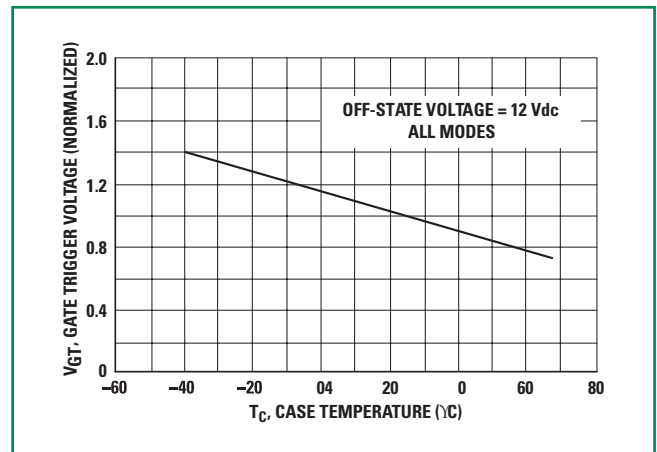

Figure 6. Typical Gate Trigger Current

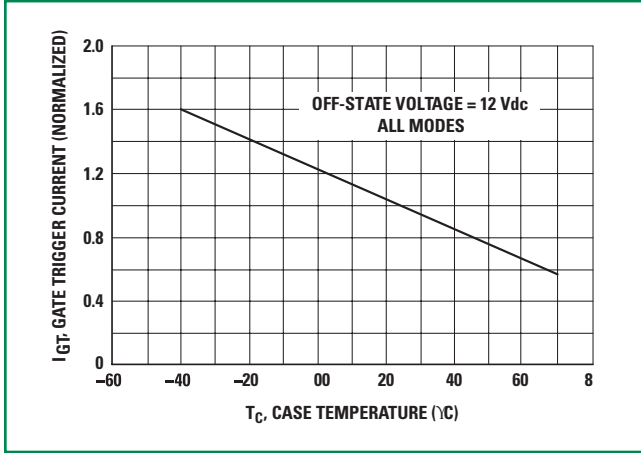
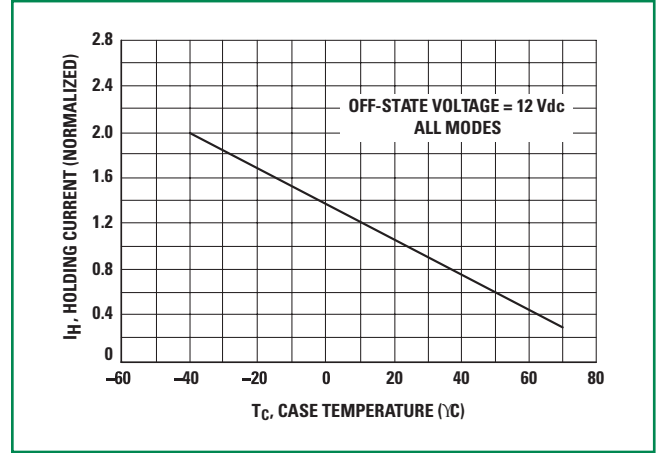
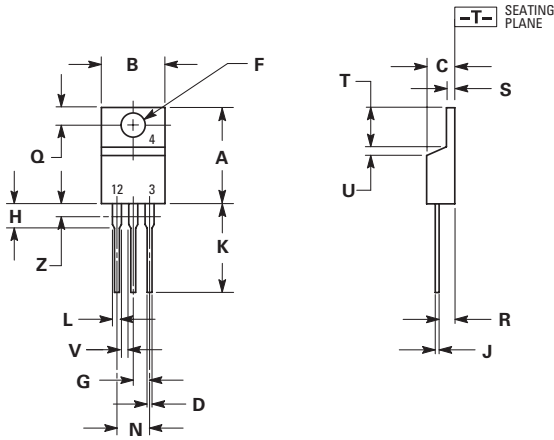

Figure 7. Typical Holding Current



Dimensions



Dim	Inches		Millimeters	
	Min	Max	Min	Max
A	0.570	0.620	14.48	15.75
B	0.380	0.405	9.66	10.28
C	0.160	0.190	4.07	4.82
D	0.025	0.035	0.64	0.88
F	0.142	0.147	3.61	3.73
G	0.095	0.105	2.42	2.66
H	0.110	0.155	2.80	3.93
J	0.014	0.022	0.36	0.55
K	0.500	0.562	12.70	14.27
L	0.045	0.060	1.15	1.52
N	0.190	0.210	4.83	5.33
Q	0.100	0.120	2.54	3.04
R	0.080	0.110	2.04	2.79
S	0.045	0.055	1.15	1.39
T	0.235	0.255	5.97	6.47
U	0.000	0.050	0.00	1.27
V	0.045	---	1.15	---
Z	---	0.080	---	2.04

1. DIMENSIONING AND TOLERANCING PER ANSI Y14.5M, 1982.
2. CONTROLLING DIMENSION: INCH.
3. DIMENSION Z DEFINES A ZONE WHERE ALL BODY AND LEAD IRREGULARITIES ARE ALLOWED.

Part Marking System

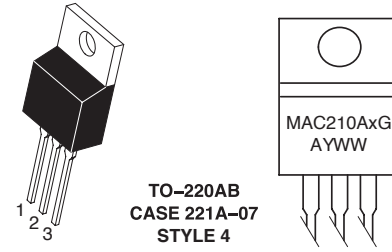

- x= 8 or 10
- A= Assembly Location
- Y= Year
- WW = Work Week
- G = Pb-Free Package

Pin Assignment

1	Main Terminal 1
2	Main Terminal 2
3	Gate
4	Main Terminal 2

Ordering Information

Device	Package	Shipping
MAC210A8	TO-220AB	500 Units/ Box
MAC210A8G	TO-220AB (Pb-Free)	
MAC210A10	TO-220AB	
MAC210A10G	TO-220AB (Pb-Free)	

Disclaimer Notice - Information furnished is believed to be accurate and reliable. However, users should independently evaluate the suitability of and test each product selected for their own applications. Littelfuse products are not designed for, and may not be used in, all applications. Read complete Disclaimer Notice at: www.littelfuse.com/disclaimer-electronics