

▲ HARDWARE SUPPLIED  
DN SWITCH

- NOTES:
1. ALL DIMENSION IN MM [INCH]
  2. GENERAL TOLERANCE: X.X=±0.4 X.XX=±0.25
  3. TERM. NOS. FOR REF. ONLY
  4. CONTACT RATING SWITCHING: 150mA, 250V AC/DC
  5. CONTACT MATERIAL: COPPER ALLOW W/SILVER PLATING
  6. OPERATING FORCE: 425±100 CM/STANDARD
  7. OPERATING TEMP: -30° to 85°C
  8. CIRCUIT SP: 3 POSITIONS, 30° INDEX.
  9. DIELECTRIC STRENGTH: 1000V RMS min. @ SEA LEVEL
  10. ▲ DENOTES CRITICAL PARAMETER
  11. HARDWARE SUPPLIED ON SWITCH - SEE BELOW STOP RING, LOCKWASHER, & HEXNUT

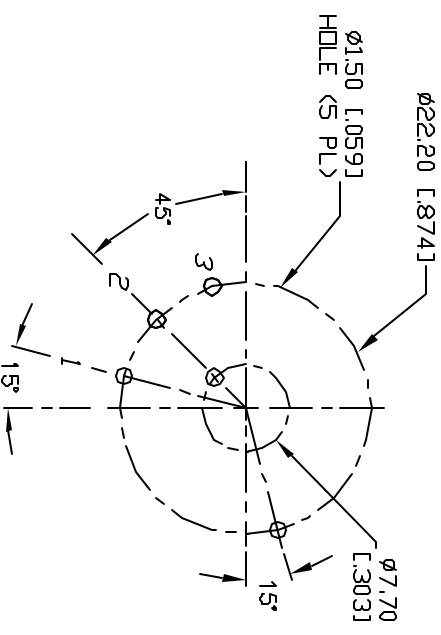
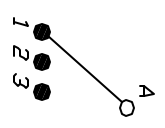

- RELEASING FOR PRODUCTION
- DATE: 7/11/03
- CHKD: AR

REV.	ECN No.	DESCRIPTION	DATE	CHKD	TITLE	SCALE	DATE	DR	DWG	REV
A	13283	RELEASED FOR PRODUCTION	7/11/03	AR	KC13A30.001NPS	1.5:1	7/11/03	AR	G527532	A
<p>THE INFORMATION CONTAINED IN THIS DOCUMENT IS PROPRIETARY TO E-SWITCH AND IS NOT TO BE COPIED OR TRANSFERRED</p>										

**E-SWITCH**®