



Copyright FCI.

A

B

C

D

A

B

C

D

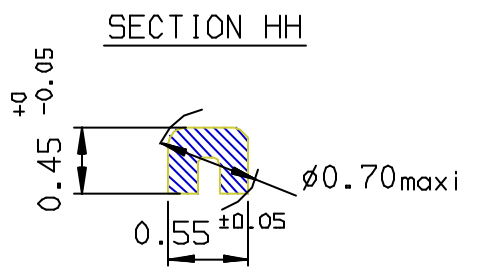
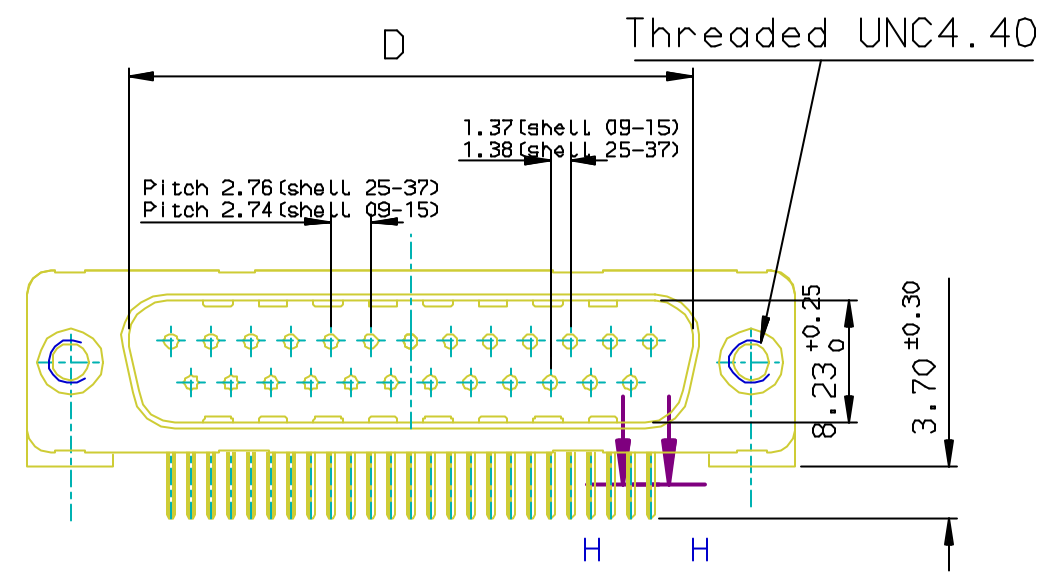
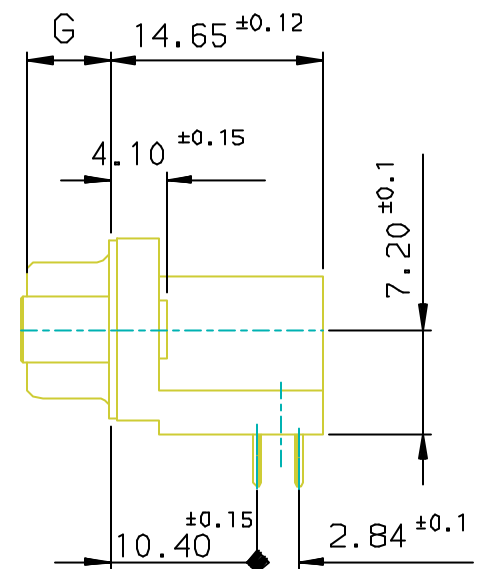
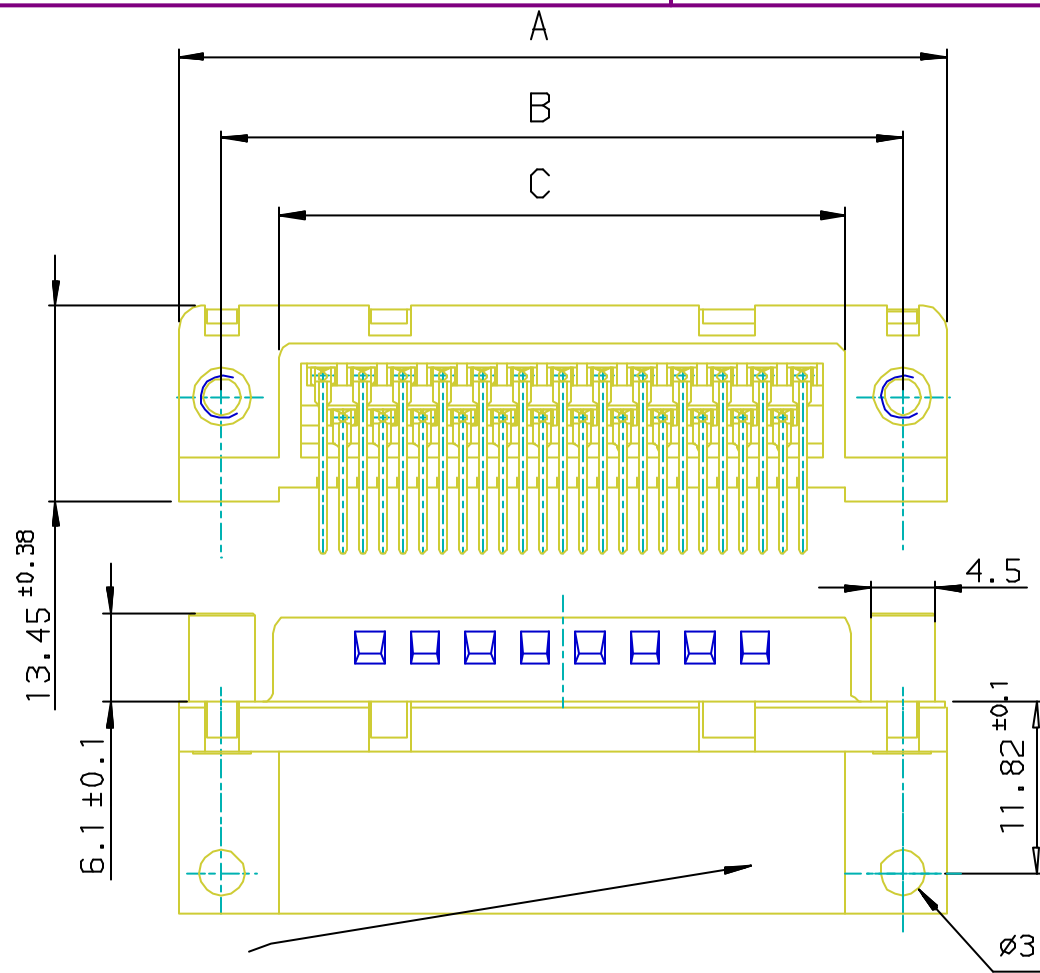

PC card drilling dimensions (after plating)
(thickness 1.60 ± 0.20 mm)

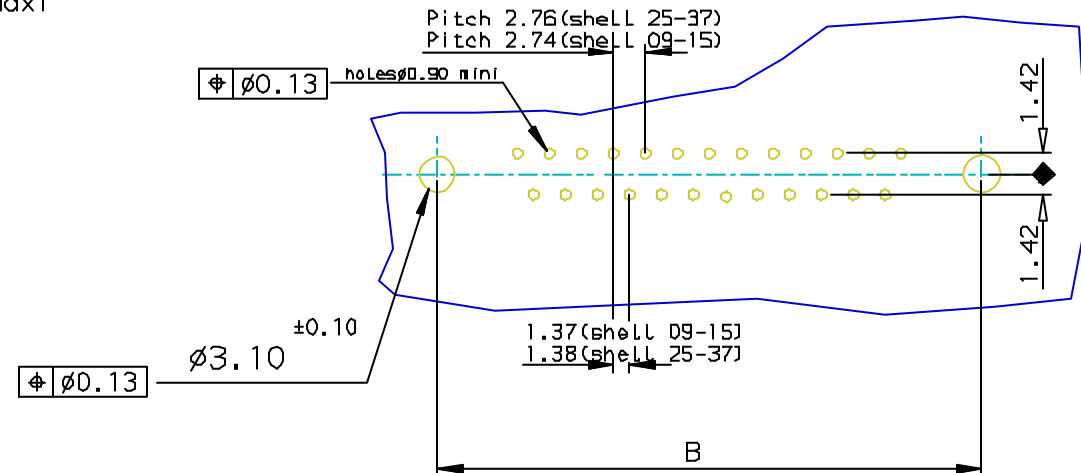

Part Number & Date Code Printing

		PART NUMBER					
SHELL	A ±0.38	B ±0.12	C ±0.10	D ±0.25	G ±0.25	Plating, 0.76 μ AU	Plating, Flash AU
09	30.81	24.99	16.96	16.79	5.90	D09P23B6PV00**	D09P23B4PV00**
15	39.14	33.32	25.18	25.12	5.90	D15P23B6PV00**	D15P23B4PV00**
25	53.03	47.04	39.12	38.84	5.70	D25P23B6PV00**	D25P23B4PV00**
37	69.32	63.50	55.68	55.30	5.70	D37P23B6PV00**	D37P23B4PV00**

LF FOR LEAD FREE

Technical characteristics:

Shell: steel tin/Zinc Cr3 plated
 Insulators: self-extinguishing black polyster, UL Class 94V0
 Contacts size 20: brass, gold on mating end, bright tin on termination end over nickel on entire contact
 Cycles: 500 for protection 6
 :200 for protection 4

Female screwlock: brass, tin plated torque: 0.7N/m

Electrical characteristics:

max. current rating: 5A
 Test voltage: 1000V
 Rated voltage: 300V
 Contact resistance: <15mΩ
 Shell resistance: <5mΩ
 Insulation resistance: >5000MΩ

Climatic characteristics:

Operating temperature range: -55°C +125°C

Dimensions:

In accordance with MIL-C-24308

FOR ROHS DETAILS REFER DWG.NO: C01-8646-0000

European Views

rev	ecn no	dr	date
B	105-0124	JS	2005/07/27
C	106-0074	SK	2006/06/08
-	-	-	-
-	-	-	-
-	-	-	-
-	-	-	-

www.fciconnect.com		surface ISO 1302 ✓	tolerance std ISO 406 ISO 1101	projection mm
TOLERANCES UNLESS OTHERWISE SPECIFIED				
Dr	JOHN SLEEBA	1999/05/17	ANGULAR	LINEAR
Eng	GEORGE VJ	1999/05/17	0.X	±0.1
Chr	GEORGE VJ	2005/07/27	0.XX	±0.1
Appr	KVSD	2005/07/27	0.XXX	±0.1
Product family			D-SUB	
title			Spec ref -	
MALE CONNECT.DELTA D RIGHT ANGLE			size A3	
WITH FEMALE SCREWLOCK.			Scale 1:1	
catalog no			ECN -	
DELTA-D			Rev. B	
Customer			C01-8646-0673	
sheet 1 of 1			Rev. B	

REV F - 2006-04-17