

1

2

3

4

5

6

7

A

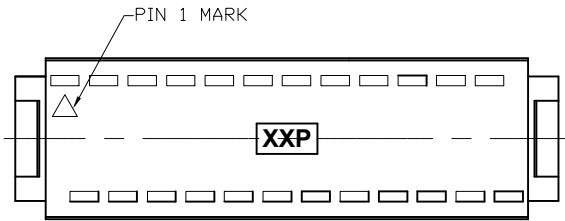

B

NOTES:

MATERIAL

- 1. Insulator Material: PBT+30%GF(UL94V-0), Black
- 2. Contact Material : Brass
- 3. Contact Plating : Sn Over Ni

ELECTRICAL

- 1. Current Rating : 3.0AMP
- 2. Withstand Voltage : 1000V AC/DC
- 4. Contact Resistance : 20mΩ max
- 5. Insulation Resistance: 1000MΩ min

ENVIRONMENTAL

- 1. Operation Temperature: -40°C to +105°C
- 2. Packing : Tray

Order Information(2.54x7.62):

contacts xx : 08,10,14,16,18,20

C

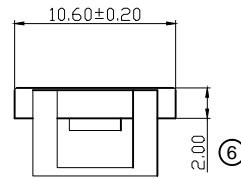
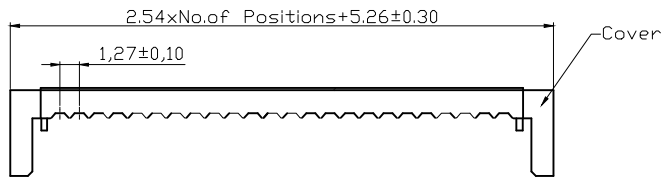

D

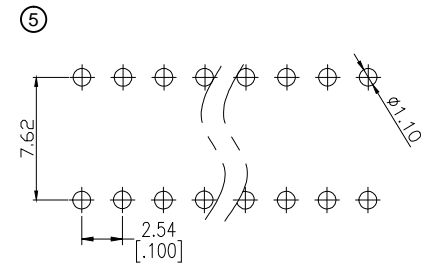
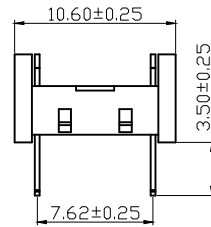
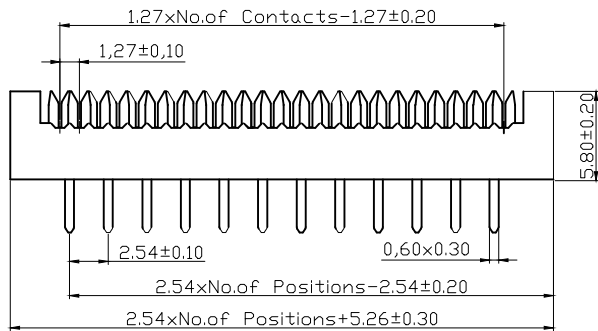

Recommended P.C.B Layout(Top Side)
(PCB BOARD TOLERANCE±0.05)

E

F

RoHS compliant

Scale	1:1	⑥	Update	15.06.2018	Xavier		Date	Name	Customer-No.
TOLERANCE		⑤	Add recommended PCB layout	16.07.2015	Ray	Drawn	25.01.2006	Alex	ASSMANN WSW-No. ADIP xx Z-LC
X.X	±0.40	④	Add sheet 2	21.01.2010	Dean	Approved	15.06.2018	Winnie	
X.XX	±0.25	③	Modify drawing	28.12.2009	Dean				
X.XXX	±0.15	②	Update	02.07.2009	Dean				Drawing-No.
Angle	±3°	①	Drawn	25.01.2006	Alex				ASS 2320 CO
		Id.	Modification	Date	Name				rev06
								Replace	Sheet 1/2

1

2

3

4

5

6

7

H

A

B

C

D

E

F

G

H

1

2

3

4

5

6

7

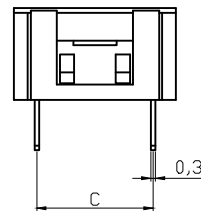
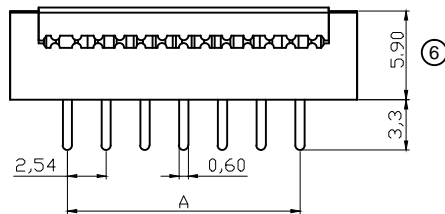
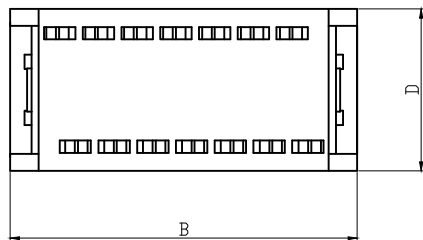

Dimensions (Pitch=15.24mm)

Positions	A	B	C	D
24	27.94	35.74	15.24	18.22
28	33.02	40.82	15.24	18.22
40	48.26	56.06	15.24	18.22

NOTES:**MATERIAL**

1. Insulator Material: PBT+30%GF(UL94V-0), Black

2. Contact Material : Brass

3. Contact Plating : Sn Over Ni

ELECTRICAL

1. Current Rating : 1.0AMP

2. Withstand Voltage : 500V AC/DC

4. Contact Resistance : 30mΩ max at 1 AMP DC.

5. Insulation Resistance: 1000MΩ at 500 VDC

ENVIRONMENTAL

1. Packing : Tray

Order Information(2.54x15.24):

contacts xx : 24,28,40

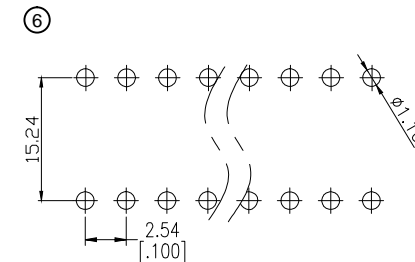
Recommended P.C.B Layout(Top Side)
(PCB BOARD TOLERANCE±0.05)**RoHS compliant**

Scale	1:1	⑥	Update	15.06.2018	Xavier		Date	Name	Customer-No.
TOLERANCE		⑤	Add recommended PCB layout	16.07.2015	Ray	Drawn	25.01.2006	Alex	ASSMANN WSW-No. ADIP xx Z-LC
X.	±0.38	④	Add sheet 2	21.01.2010	Dean	Approved	15.06.2018	Winnie	
X.X	±0.25	③	Modify drawing	28.12.2009	Dean				
X.XX	±0.13	②	Update	02.07.2009	Dean				
Angle		①	Drawn	25.01.2006	Alex				Drawing-No. ASS 2320 CO
X°	±3°								
X.X°	±1°								Replace
		Id.	Modification	Date	Name				

1

2

3

4

5

6

7