

Housing - VC-AL-T4-Z-M25/M20-S - 1583746

Please be informed that the data shown in this PDF Document is generated from our Online Catalog. Please find the complete data in the user's documentation. Our General Terms of Use for Downloads are valid (<http://download.phoenixcontact.com>)



Aluminum die-cast sleeve housing, with grommet, locking screws with cylinder head, for two metric cable glands M25 and M20, angled cable outlet, type VC4

Product Features

- Housing with two cable entries for M20 and M25 screw connections.
- Angled cable outlet so the cable can be routed as desired, from the side and straight
- Aluminum housing with extended cabling space for high-position and power contact inserts



Key commercial data

Packing unit	1 PCE
Weight per Piece (excluding packing)	298.65 GRM
Custom tariff number	85369010
Country of origin	Poland

Technical data

Dimensions

Height	90 mm
--------	-------

Ambient conditions

Ambient temperature (operation)	-40 °C ... 125 °C
---------------------------------	-------------------

General

Note	When using fiber optics, the bending radii of the cable manufacturers must be observed.
Design	VC4
Color	gray aluminum
Locking type	Screw locking, cylinder head
Fixing screws	M4
No. of cable exits	2

Housing - VC-AL-T4-Z-M25/M20-S - 1583746

Technical data

General

Cable exit	Angled
Screw connection	None
Type of the screw connection	M25/M20 x 1.5
Housing material	Aluminum die-cast
Seal material	NBR, conductive
Material of locking screw	V2A
Inflammability class according to UL 94	V0

Classifications

eCl@ss

eCl@ss 4.0	272607xx
eCl@ss 4.1	27260701
eCl@ss 5.0	27143424
eCl@ss 5.1	27143424
eCl@ss 6.0	27371205
eCl@ss 7.0	27371205
eCl@ss 8.0	27371205

ETIM

ETIM 3.0	EC000437
ETIM 4.0	EC000437
ETIM 5.0	EC000437

UNSPSC

UNSPSC 6.01	31261502
UNSPSC 7.0901	31261502
UNSPSC 11	31261502
UNSPSC 12.01	31261502
UNSPSC 13.2	31261502

Approvals

Approvals

Approvals

GOST

Housing - VC-AL-T4-Z-M25/M20-S - 1583746

Approvals

Ex Approvals

Approvals submitted

Approval details

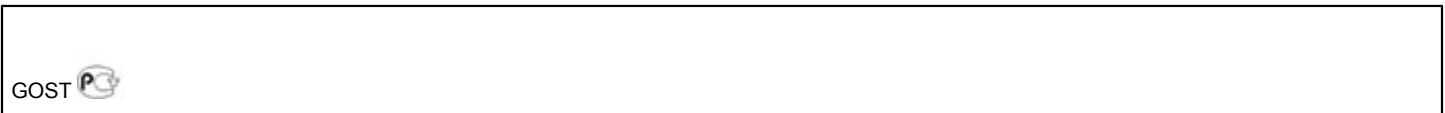

Accessories

Accessories

Device marking

Engraving material - GPE 22X22 SR/R - 0806628



Engraving material, Sheet, silver, Unlabeled, Can be labeled with: Engraving, Plotter, Mounting type: Adhesive, Lettering field: 22 x 22 mm

Full screw connection

Cable gland - HC-M-KV-M20(9-13) - 1690561



Metal screw connection up to 5 bar, thread length: 6 mm, cable diameter: 9 - 13 mm, WAF 22, screw connection: M20

Cable gland - HC-M-KV-M20(11-16) - 1645998



Metal screw connection up to 5 bar, thread length: 6 mm, cable diameter: 11 - 16 mm, WAF 27, screw connection: M20

Housing - VC-AL-T4-Z-M25/M20-S - 1583746

Accessories

Cable gland - HC-EMV-KV-M20(7-12,5) - 1690503



EMC screw connection up to 5 bar, thread length: 5 mm, cable diameter: 7.0 - 12.5 mm, WAF 24, screw connection: M20

Cable gland - HC-M-KV-M25(11-16) - 1690574



Metal screw connection up to 5 bar, thread length: 7 mm, cable diameter: 11 - 16 mm, WAF 27, screw connection: M25

Cable gland - HC-M-KV-M25(14-21) - 1646007



Metal screw connection up to 5 bar, thread length: 7 mm, cable diameter: 14 - 21 mm, WAF 34, screw connection: M25

Cable gland - HC-EMV-KV-M25(9-16,5) - 1690516



EMC screw connection up to 5 bar, thread length: 7.5 mm, cable diameter: 9.0 - 16.5 mm, WAF 29, screw connection: M25

Drawings

Housing - VC-AL-T4-Z-M25/M20-S - 1583746

Dimensioned drawing

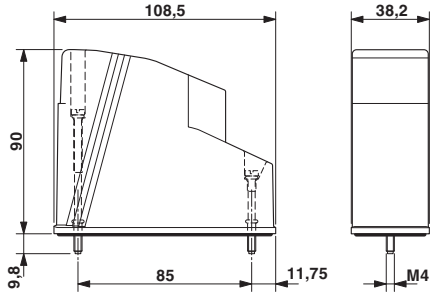

Dimensioned drawing

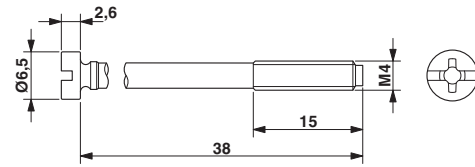

Dimensioned drawing

